



9 Badger Sett, Blandford St Mary, Dorset, DT11 9QL





A fine example of a two bedroom terraced property situated on this award winning estate in Blandford St. Mary.

The property benefits from a garage, master bedroom with en-suite and No Forward Chain

This two bedroom terraced property benefits from a garage and is offered to the market with no forward chain.

Upon entering the property you are welcomed into the entrance hall, with stairs to first floor, access to all ground floor rooms and a useful downstairs WC.

The kitchen comprises a range of base and wall units providing cupboard and drawer storage, window overlooking the front aspect of the property, space for cooker and washing machine with an integral fridge freezer.



The living/dining room spans the entire width of the property with double window overlooking the rear garden and double doors providing access to same.

To the first floor are two double bedrooms, with bedroom one benefiting from an en-suite shower room.

The family bathroom comprises a panelled bath, low level WC, wash hand basin and obscured glazed window to rear aspect.

The rear garden has split levels, with steps leading from the area adjacent to the property down to the remainder of the garden.



The garage is situated to the rear of the garden, with access via a single door.

£300,000 Freehold

GROUND FLOOR
378 sq.ft. (35.1 sq.m.) approx.

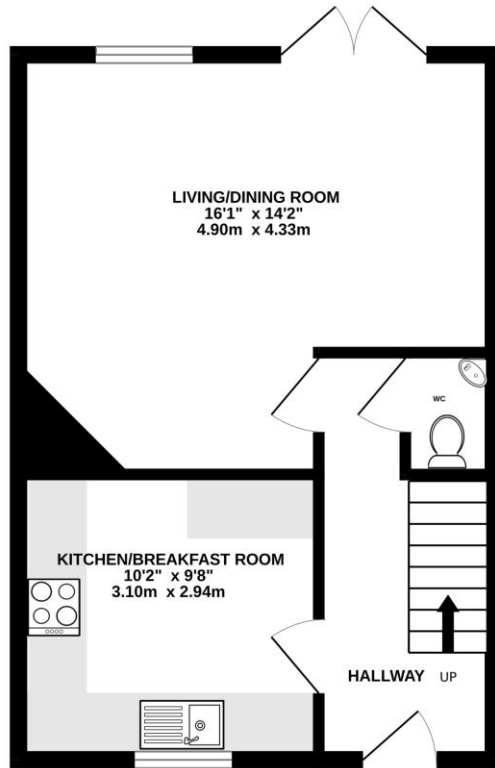

1ST FLOOR
384 sq.ft. (35.6 sq.m.) approx.

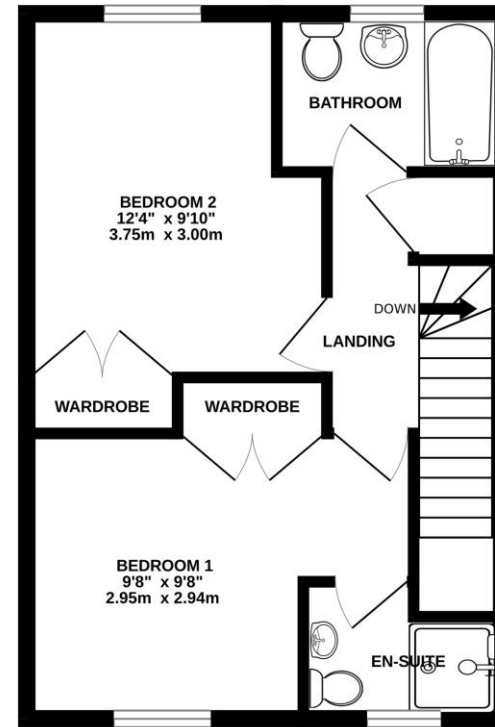

TOTAL FLOOR AREA : 761 sq.ft. (70.7 sq.m.) approx.

Whilst every attempt has been made to ensure the accuracy of the floorplan contained here, measurements of doors, windows, rooms and any other items are approximate and no responsibility is taken for any error, omission or mis-statement. This plan is for illustrative purposes only and should be used as such by any prospective purchaser. The services, systems and appliances shown have not been tested and no guarantee as to their operability or efficiency can be given.
Made with Metropix ©2024

Please note Forum Sales & Lettings and their client give notice that:

1. They have no authority to make or give any representation or warranties in relations to the property. These particulars do not form part of any offer or contract and must not be relied upon as statements or representations of fact.
2. Any areas, common measurements or distances are approximate. The text, photographs and plans are for guidance only and are not necessarily comprehensive. It should not be assumed that the property has all necessary Planning, Building Regulations or other consents and Forum Sales and Lettings have not tested any services, equipment or facilities. Purchasers must satisfy themselves by inspection or otherwise.

EPC Rating - C

Viewing Arrangements - Strictly by appointment with Forum Sales & Lettings

15 Salisbury Street, Blandford Forum, Dorset, DT11 7AU

Tel: 01258 459600