

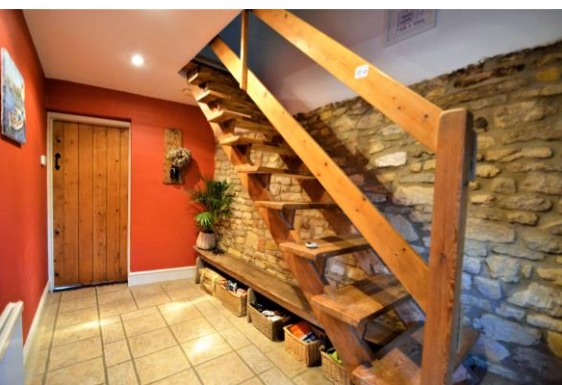

High Street, Cricklade, Wiltshire.

Monthly Rental Of £1,250



7 High Street, Cricklade, Wiltshire.

DIRECTIONS

Please use the postcode SN6 6AP or call the office at any time for detailed directions from your location.

SUMMARY

Charming period town house, immaculately presented throughout and situated in a convenient position close to the many local amenities of this popular Saxon town. Spacious and flexible accommodation including an open plan kitchen/dining room overlooking the private and westerly facing rear garden.

PROPERTY

Crossing the threshold of this beautiful townhouse brings you into a generous entrance hallway with a charming feature of an Oak staircase against a Cotswold stone wall. You are then met with the kitchen / diner which has access to the rear garden. The kitchen is a wonderful example of the charm you would expect to find in a period cottage of this caliber and comprises the modern conveniences of a range of cupboards and drawers with built in appliances including oven, hob, and sink with drainer whilst offering additional plumbing and space for a washing machine and fridge freezer and all the while maintaining the integrity and character of a period property. The sitting room benefits from exposed stone, traditional wooden doors and a deep windowsill while the fireplace holds an electric fire.

Up to the first floor and you are met with lovely parquet flooring of the landing which leads to each of the generously sized bedrooms as well as the family bathroom. The master bedroom is, as is with the entire house, tastefully decorated to enhance all of the features of the room. The second bedroom has built in wardrobe storage and a view over the back garden and the third bedroom, currently the nursery, boasts useful and almost hidden storage space and a lovely view of the green across the road. The family bathroom comprises a white suite of wash hand basin, WC and P shaped bath.

GARDENS

The garden has been thoughtfully landscaped and offers an area of lawn, decking and a summerhouse which offers power and light. Further benefits include a high degree of privacy and a westerly aspect. Although the property does not have a drive, parking is never an issue for the vendors who have two cars themselves and always find parking available in the nearby Town Hall, on street and cul de sac's.

LOCATION

The property is located on the High Street of this ever popular town and is close to the many amenities it has to offer. Cricklade is a desirable Saxon Town with a wide range of facilities including doctors, pubs, local grocers and butchers, whilst still offering easy access to the local road and rail network.

VIEWING

Viewing is available by appointment 7 days a week. Please call your local office to arrange.

FEES

Please check the full online listing, our website, or speak to a member of the team to discuss any fees which may be payable.

AGENTS NOTE

We wish to inform prospective purchasers that we have prepared these sales particulars as a general guide. We have not carried out a survey, nor have we tested any services, appliances or any specific fittings at the property. Room sizes should not be relied upon for carpets and furnishings.

GROUND FLOOR

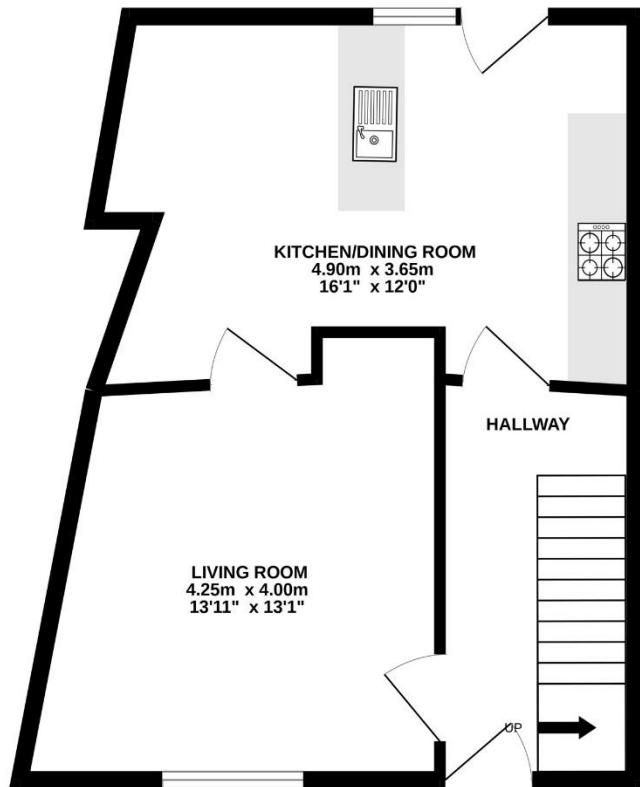

1ST FLOOR

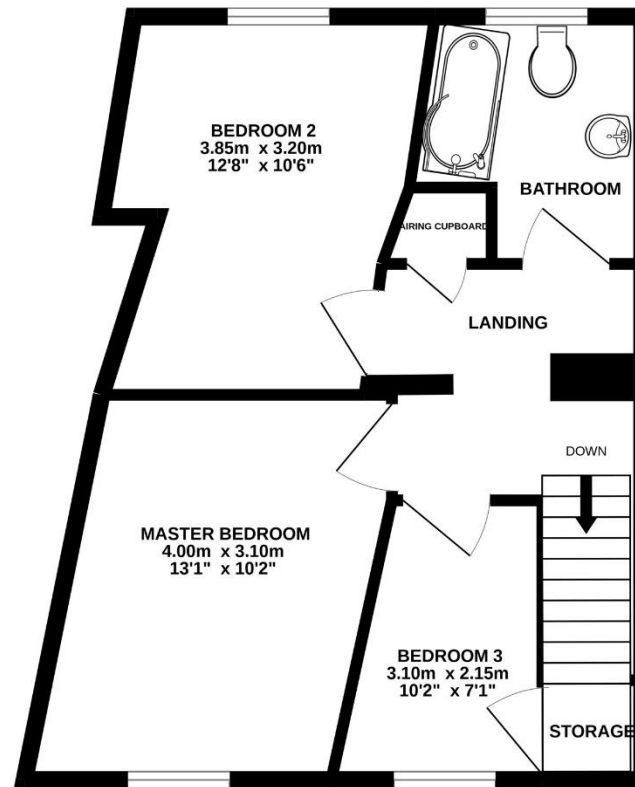

Whilst every attempt has been made to ensure the accuracy of the floorplan contained here, measurements of doors, windows, rooms and any other items are approximate and no responsibility is taken for any error, omission or mis-statement. This plan is for illustrative purposes only and should be used as such by any prospective purchaser. The services, systems and appliances shown have not been tested and no guarantee as to their operability or efficiency can be given.
Made with Metropix ©2022



