





WV29, Willow View, Cotswold Hoburne, Cotswold Lakes.

DIRECTIONS

Please use the postcode GL7 5UQ or call the office at any time for detailed directions from your location.

SUMMARY

Larger than average holiday home which is perfectly situated for access to the nearby fishing lakes as well as the facilities offered in the onsite entertainment complex. The spacious accommodation includes a welcoming entrance hall, well equipped kitchen, separate dining and sitting areas, two bedrooms with built in wardrobes, ensuite wc, and large shower room. Further benefits include parking, southerly facing decking and attractive communal gardens.

PROPERTY

This larger than average property is accessed via a welcoming entrance hall with useful storage cupboards. Turning to the left takes you into the dining area which is open to the well equipped kitchen/breakfast room with a range of built in storage and appliances. The dual aspect living room has doors out to the southerly facing decking, as well as a feature fireplace.

The master bedroom benefits from built in wardrobes and an ensuite with wc and wash hand basin. There is a second twin room which also has built in storage. The property is completed by the larger than usual shower room fitted with a suite comprising shower cubicle, wc, and wash hand basin.

GARDENS

The property benefits from a southerly facing decking and has a private parking space adjacent to it. It also takes advantage of this luxurious development with plenty of communal gardens, as well as leisure amenities, to enjoy.

LOCATION

The property is perfectly situated with easy access to the fishing lakes and main complex of the exclusive Cotswold Hoburne resort in the heart of the Cotswold Lakes. Facilities include the impressive entertainment complex which include children's play area, bar, and restaurant, indoor and outdoor heated pools, boating and fishing lakes, adventure golf, tennis court, multi-use games area, adventure playground, amusement arcade, shop, and much more! It is located on the edge of South Cerney which is an attractive village with a further shops and popular pubs and is within easy reach of the many beautiful walks and leisure facilities that the Cotswold Water Park has to offer.

VIEWING

Viewing is available by appointment 7 days a week. Please call your local office to arrange.

AGENTS NOTE

We wish to inform prospective purchasers that we have prepared these sales particulars as a general guide. We have not carried out a survey, nor have we tested any services, appliances or any specific fittings at the property. Room sizes should not be relied upon for carpets and furnishings.

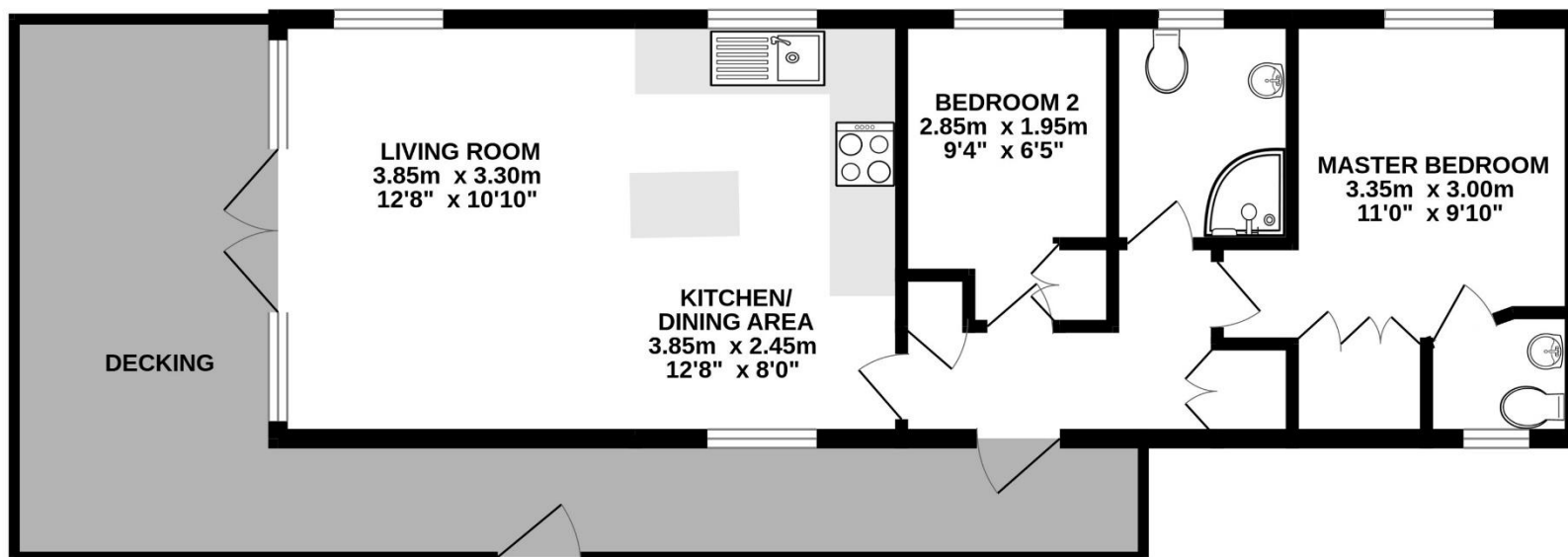

Whilst every attempt has been made to ensure the accuracy of the floorplan contained here, measurements of doors, windows, rooms and any other items are approximate and no responsibility is taken for any error, omission or mis-statement. This plan is for illustrative purposes only and should be used as such by any prospective purchaser. The services, systems and appliances shown have not been tested and no guarantee as to their operability or efficiency can be given.
Made with Metropix ©2025



