





RM9, Reed Meadow, Cotswold Hoburne, Cotswold Lakes, Gloucestershire.

DIRECTIONS

Please use the postcode GL7 5UQ or call the office at any time for detailed directions from your location.

SUMMARY

Detached holiday lodge, located in a quiet tucked away position in the desirable 'Meadows' development at Cotswold Hoburne within the Cotswold Lakes. Experience all the luxury benefits of Cotswold Reach, but on the same side of the road as all of the amenities and offering much better value for money! This particular property is currently used for personal holiday use only and so is exceptionally well presented throughout. Get in touch for more info.

PROPERTY

The property is access from the decking into a useful utility area with storage cupboard as well as a washing machine, sink, and further storage. This leads through to a large, triple aspect living room with separate sitting and dining areas, feature fireplace, and patio doors to the decking. The dining area is open to the kitchen which is fitted with a range of storage appliances including oven, hob, hood, and dishwasher. The inner hall leads through to the two bedrooms and the 'Jack & Jill' shower room which is fitted with a shower cubicle, wc, wash hand basin. The master bedroom benefits from a dressing area with wardrobes and an ensuite fitted with a bath with shower over, wc, and wash hand basin. The second bedroom also has built in storage as well as direct access to the shower room.

GARDENS

The property benefits from allocated parking and an attractive area of private southerly facing decking, as well as plenty of space around. It also takes advantage of this luxurious development with plenty of communal gardens, as well as leisure amenities, to enjoy.

LOCATION

The property is located at the end of a quiet cul de sac in the 'Meadows' area of Cotswold Hoburne resort, which is in the heart of the Cotswold Lakes. Facilities include an impressive entertainment complex which include children's play area, bar, and restaurant, indoor and outdoor heated pools, boating and fishing lakes, adventure golf, tennis court, multi-use games area, adventure playground, amusement arcade, shop, and much more! It is located on the edge of South Cerney which is an attractive village with a further shops and popular pubs and is within easy reach of the many beautiful walks and leisure facilities that the Cotswold Lakes have to offer.

VIEWING

Viewing is available by appointment 7 days a week. Please call your local office to arrange.

AGENTS NOTE

We wish to inform prospective purchasers that we have prepared these sales particulars as a general guide. We have not carried out a survey, nor have we tested any services, appliances or any specific fittings at the property. Room sizes should not be relied upon for carpets and furnishings.

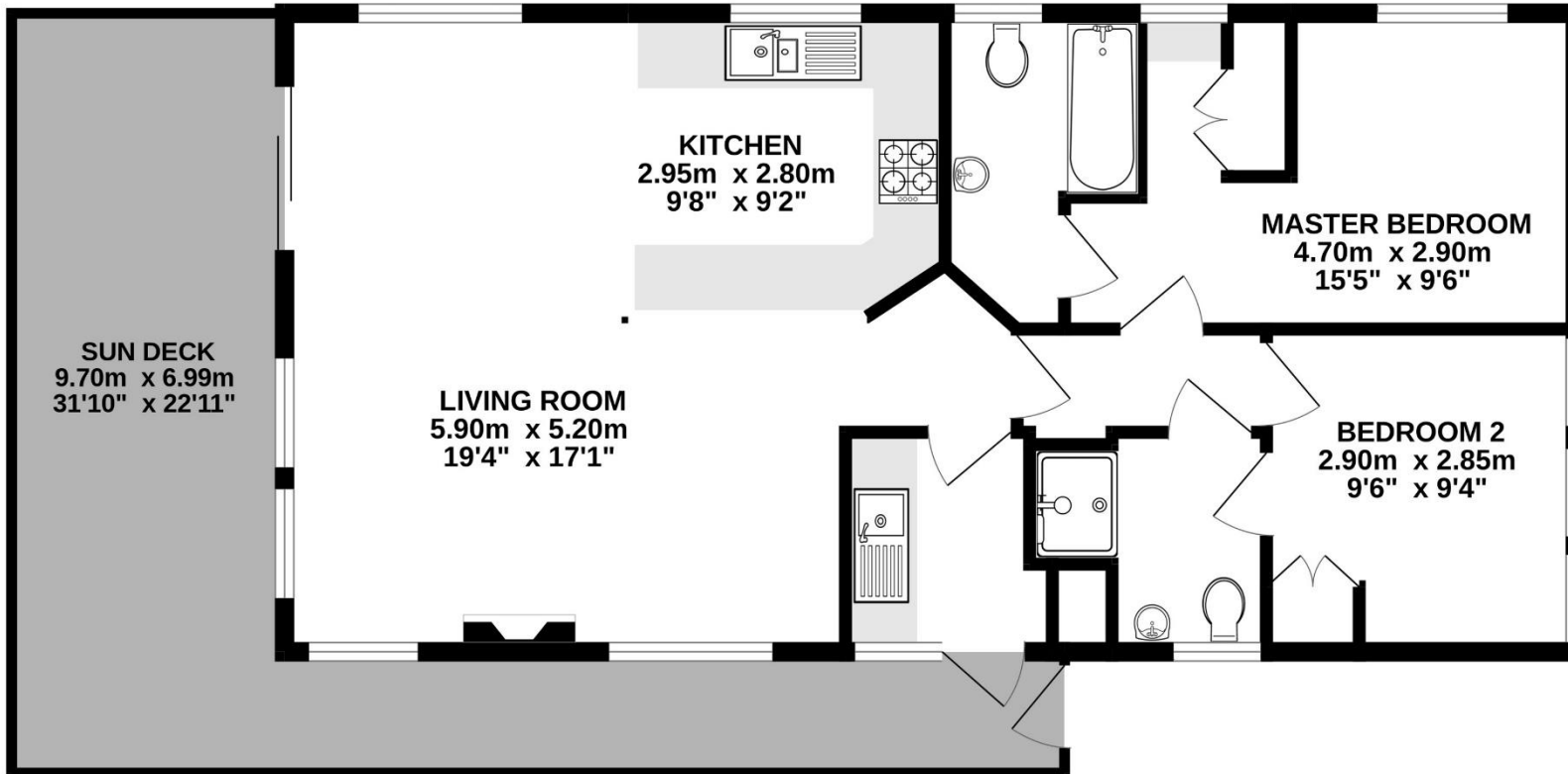

Whilst every attempt has been made to ensure the accuracy of the floorplan contained here, measurements of doors, windows, rooms and any other items are approximate and no responsibility is taken for any error, omission or mis-statement. This plan is for illustrative purposes only and should be used as such by any prospective purchaser. The services, systems and appliances shown have not been tested and no guarantee as to their operability or efficiency can be given.
Made with Metropix ©2025



