





21 Woodhouse Close, Cirencester, Gloucestershire.

DIRECTIONS

Please use the postcode GL7 1YH or call the office at any time for detailed directions from your location.

SUMMARY

Situated in a quiet, tucked away position in this desirable residential area is this good size home with enclosed rear garden, garage and parking. The accommodation includes two double bedrooms, family bathroom, spacious living room, and kitchen breakfast room with doors out to the rear garden. It is convenient for local Chesterton amenities as well as the town centre, and is offered for sale with no onward chain.

PROPERTY

The property is accessed from the front into a spacious living room with stairs leading to the first floor. A door leads through to the kitchen/breakfast room which is fitted with a range of storage and appliance space. There is a breakfast area with doors leading out to the garden and space for a dining table. To the first floor are two good size double rooms. In between is a bathroom fitted with a suite comprising bath with shower over, wc, and wash hand basin. There is an airing cupboard and further storage cupboard.

GARDENS

To the front of the property is a small garden with path leading to the front door. There is a garage opposite with up and over door to the front, and a parking space in front. The rear garden is enclosed by fencing and is mainly laid to lawn with shrub borders.

LOCATION

The property is located in a quiet close in a popular residential area on the outskirts of this popular town with easy access to local amenities as well as the town centre and road and rail network beyond. Local amenities including a local surgery, shops and chemist as well as primary school, Deer Park secondary school and Cirencester College.

VIEWING

Viewing is available by appointment 7 days a week. Please call your local office to arrange.

MORTGAGE

We advise potential purchasers to speak to Financial Associates to discuss their financial requirements. Call us for further information.

AGENTS NOTE

We wish to inform prospective purchasers that we have prepared these sales particulars as a general guide. We have not carried out a survey, nor have we tested any services, appliances or any specific fittings at the property. Room sizes should not be relied upon for carpets and furnishings.

GROUND FLOOR

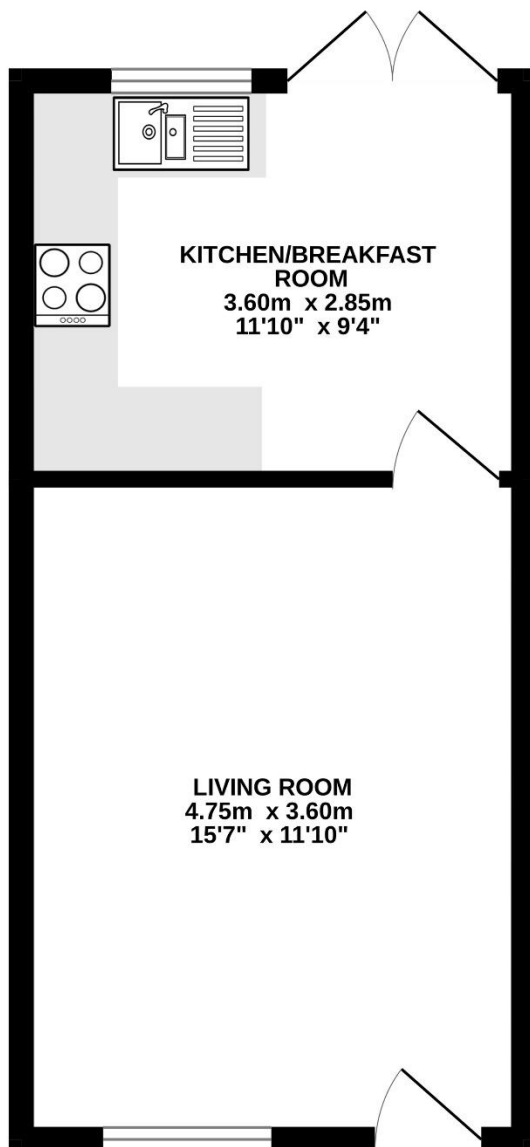

1ST FLOOR

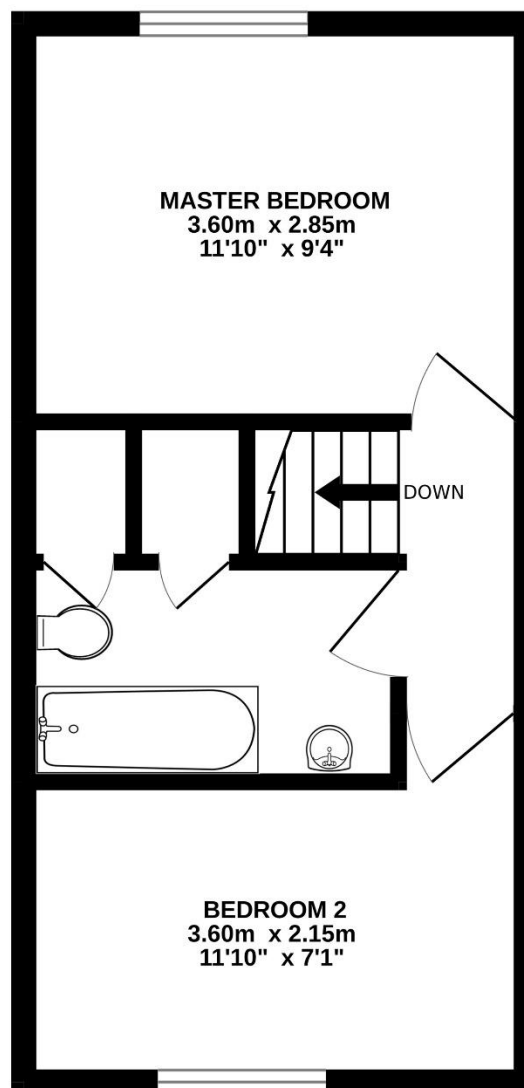

Whilst every attempt has been made to ensure the accuracy of the floorplan contained here, measurements of doors, windows, rooms and any other items are approximate and no responsibility is taken for any error, omission or mis-statement. This plan is for illustrative purposes only and should be used as such by any prospective purchaser. The services, systems and appliances shown have not been tested and no guarantee as to their operability or efficiency can be given.
Made with Metropix ©2025



