





OM2, Oak Meadow, Cotswold Hoburne, Gloucestershire.

DIRECTIONS

Please use the postcode GL7 5UQ or call the office at any time for detailed directions from your location.

SUMMARY

Superbly presented holiday home with southerly facing decking which has a sunken hot tub. It is located on the exclusive 'Meadows' section of the popular Cotswold Hoburne holiday park. Benefits include adjacent parking, and spacious well presented accommodation which includes a master bedroom suite with dressing room and ensuite with bath. It takes full advantage of the many leisure amenities of the development, as well as the rest of the Cotswold Lakes beyond.



PROPERTY

The front door enters into a good size kitchen/dining room which is fitted with a range of storage options as well as high quality integral appliances including a washing machine and dishwasher. It is open to the living room which is a beautiful triple aspect room with feature fireplace and patio doors that lead out to the southerly facing decking with hot tub. The furniture in this room includes a useful sofa bed. The inner hall provides access to the two bedrooms and family shower room which is fitted with a suite comprising shower cubicle, wc, and wash hand basin. The master bedroom suite is fitted with a dressing table and storage with a door leading through to a dressing area with built in wardrobes as well as the ensuite bathroom fitted with a suite comprising bath with shower over, wc, and wash hand basin. The second bedroom has twin beds and fitted storage.



GARDENS

The property benefits from adjacent private parking and a southerly facing deck with sunken hot tub which is a rarely available option and cannot be added to existing homes. It also takes advantage of this luxurious development with plenty of communal gardens, as well as leisure amenities, to enjoy.

LOCATION

The property is located on the exclusive Cotswold Hoburne resort in the heart of the Cotswold Lakes. Facilities include an impressive entertainment complex which include children's play area, bar and restaurant, indoor and outdoor heated pools, boating and fishing lakes, adventure golf, tennis court, multi-use games area, adventure playground, amusement arcade, shop, and much more! It is located on the edge of South Cerney which is an attractive village with a further shops and popular pubs and is within easy reach of the many beautiful walks and leisure facilities that the Cotswold Lakes area has to offer.

VIEWING

Viewing is available by appointment 7 days a week. Please call your local office to arrange.

AGENTS NOTE

We wish to inform prospective purchasers that we have prepared these sales particulars as a general guide. We have not carried out a survey, nor have we tested any services, appliances or any specific fittings at the property. Room sizes should not be relied upon for carpets and furnishings.

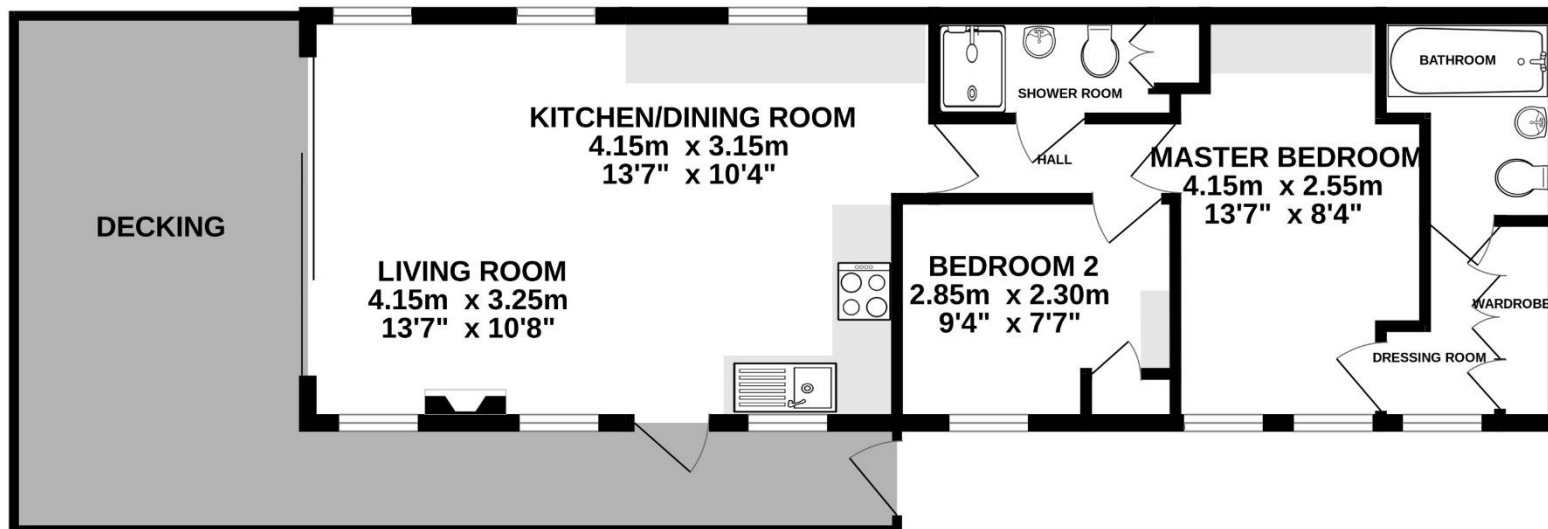

Whilst every attempt has been made to ensure the accuracy of the floorplan contained here, measurements of doors, windows, rooms and any other items are approximate and no responsibility is taken for any error, omission or mis-statement. This plan is for illustrative purposes only and should be used as such by any prospective purchaser. The services, systems and appliances shown have not been tested and no guarantee as to their operability or efficiency can be given.
Made with Metropix ©2024



