





18 John Tame Close, Fairford, Gloucestershire.

DIRECTIONS

Please use the postcode GL7 4NP or call the office at any time for detailed directions from your location.

SUMMARY

Situated in a private position in this quiet close is this semi-detached, three bedroom family home. The accommodation includes open plan living/dining room as well as a modern kitchen, whilst upstairs are three good size bedrooms and a family bathroom. Further benefits include driveway parking and garden.

PROPERTY

The property is accessed via an entrance area with stairs rising to the first floor. To the left is a good size living room which is open to the dining room with patio door providing access to the garden. It is open to the kitchen which is fitted with a range of storage and appliance space. The first floor landing has a useful airing cupboard and access to the three good sized bedrooms and the family bathroom. The master bedroom is particularly large and is situated towards the front of the property. The bathroom is fitted with a bath and over head shower, wc, large heated towel rail, and sink.

GARDENS

To the front of the property is a small garden laid to lawn with mature shrubs and a path leading to the front door. There is driveway parking for two cars. There is gated access to the enclosed rear garden which has a patio adjoining the house and is mostly laid to lawn with mature shrub borders.

LOCATION

The property is located in a quiet close within easy reach of this popular town. Fairford is a delightful market town with a wide range of local amenities including schools, restaurants, doctors, dentists and a range of shops.

VIEWING

Viewing is available by appointment 7 days a week. Please call your local office to arrange.

MORTGAGE

We advise potential purchasers to speak to Financial Associates to discuss their financial requirements. Call us for further information.

AGENTS NOTE

We wish to inform prospective purchasers that we have prepared these sales particulars as a general guide. We have not carried out a survey, nor have we tested any services, appliances or any specific fittings at the property. Room sizes should not be relied upon for carpets and furnishings.

01285 641839

cirencester@cbslade.co.uk

01793 752382

cricklade@cbslade.co.uk

www.cbslade.co.uk

GROUND FLOOR

1ST FLOOR

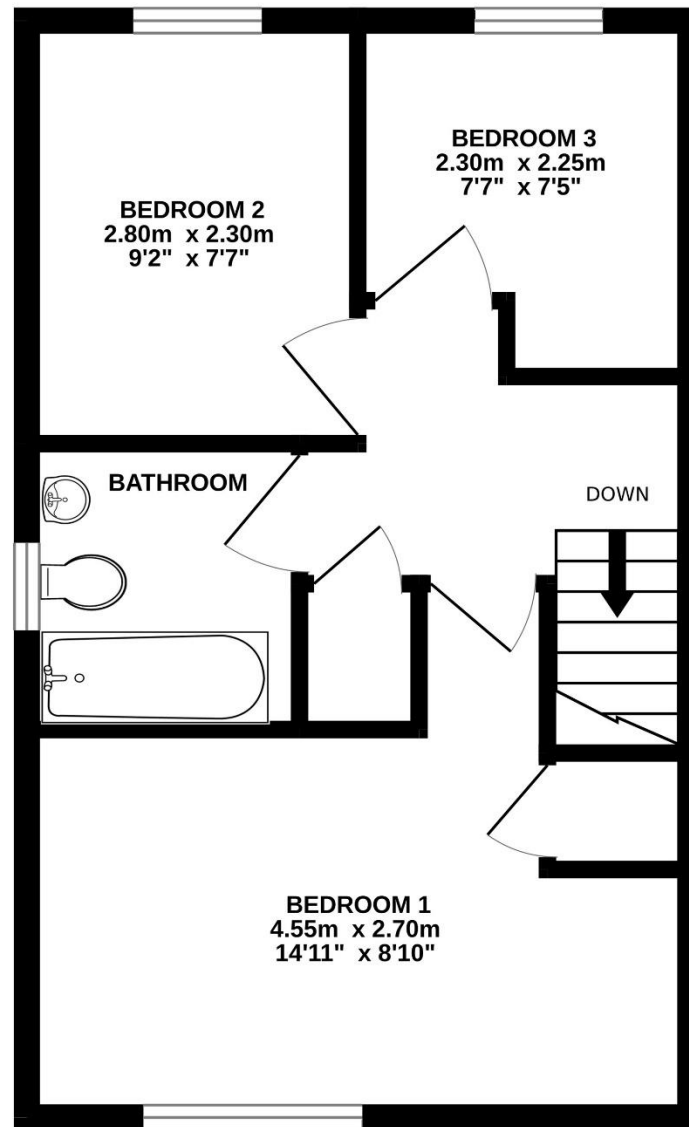
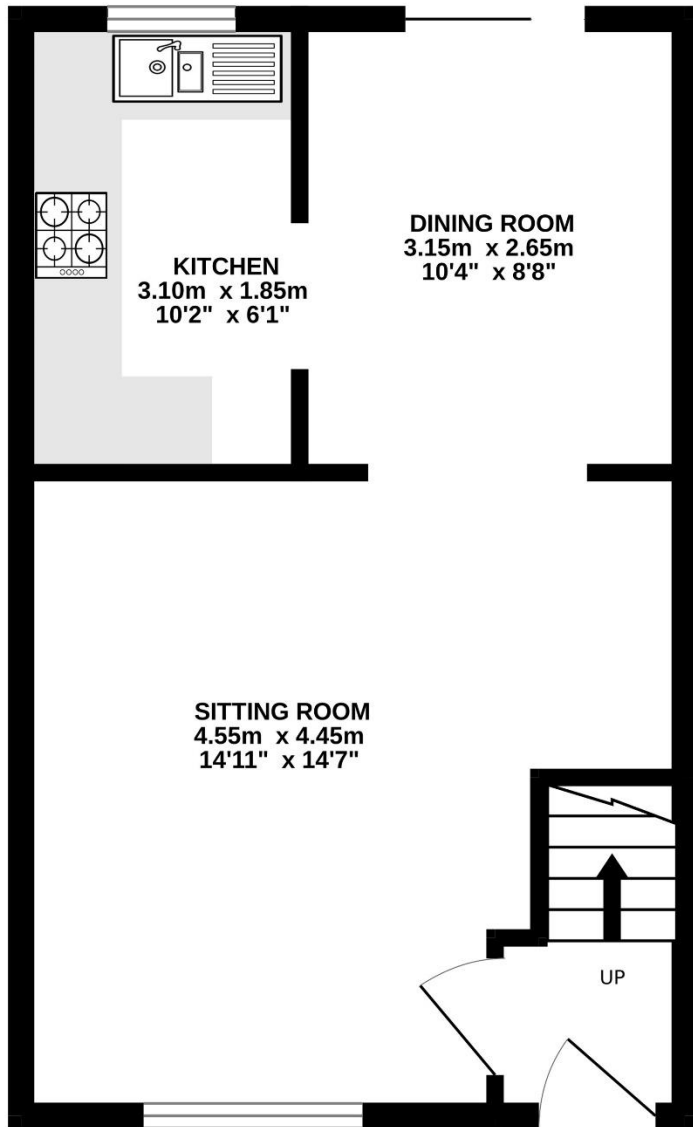

Whilst every attempt has been made to ensure the accuracy of the floorplan contained here, measurements of doors, windows, rooms and any other items are approximate and no responsibility is taken for any error, omission or mis-statement. This plan is for illustrative purposes only and should be used as such by any prospective purchaser. The services, systems and appliances shown have not been tested and no guarantee as to their operability or efficiency can be given.
Made with Metropix ©2024

