

Flat 1, 98 High Street, Cricklade, Wiltshire.

DIRECTIONS

Please use the postcode SN6 6AA or call the office at any time for detailed directions from your location.

SUMMARY

This light and spacious, first floor, two bedroom apartment is well presented throughout and ideally located close to many local amenities. The accommodation includes large living area, kitchen including white goods, generous sized master bedroom and modern bathroom.

PROPERTY

The first floor apartment comprises two large double bedrooms, a large living room and a kitchen/dining room offering a range of cupboards and drawers with built in appliances including oven and hob whilst there is further space for white goods. The accommodation is finished with a bathroom comprising a modern white suite including bath with electric shower, wc and wash hand basin. The current vendors have invested in redecorating the apartment throughout and have also replaced the majority of the carpets.

OUTSIDE

The property is accessed via a shared passage way tucked off of the High Street. Parking is available within the High Street and is unrestricted and free.

LOCATION

The property is located in a central position within the High Street of this ever popular town and is close to the many amenities it has to offer. Cricklade is a desirable Saxon Town with a wide range of facilities including public houses, local grocers and butchers whilst still offering easy access to the local road and rail network.

VIEWING

Viewing is available by appointment 7 days a week. Please call your local office to arrange.

FEES

Please see the full online listing, our website, in our office, or speak to a member of the team for a full list of fees which may be applicable.

AGENTS NOTE

We wish to inform prospective purchasers that we have prepared these sales particulars as a general guide. We have not carried out a survey, nor have we tested any services, appliances or any specific fittings at the property. Room sizes should not be relied upon for carpets and furnishings.

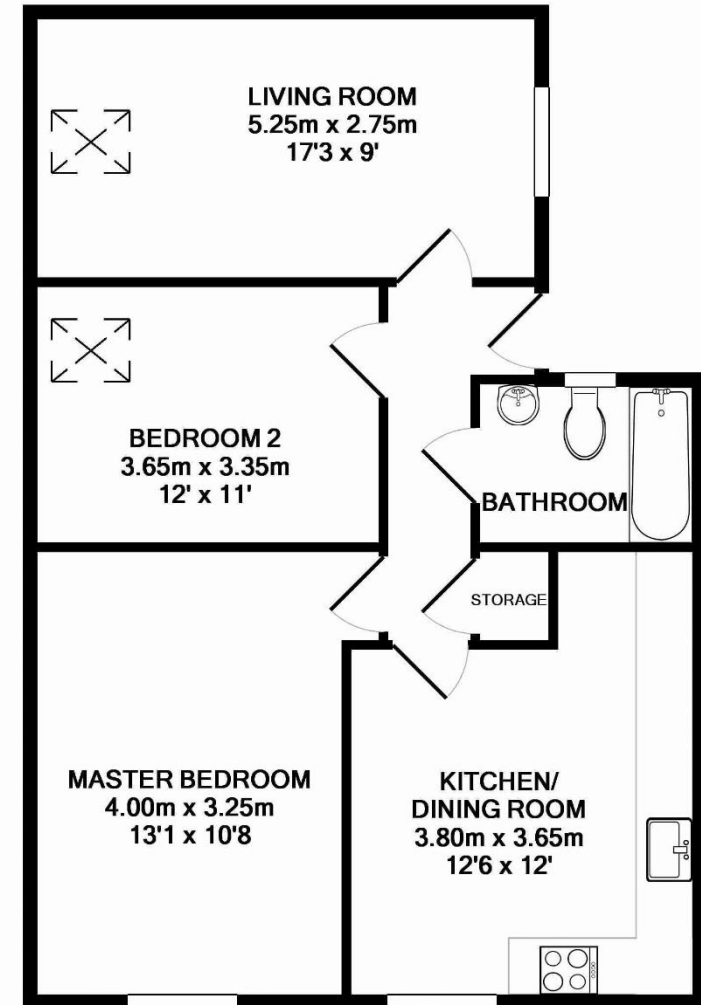

Measurements are approximate. Not to scale. Illustrative purposes only
Made with Metropix ©2014

