





11 Spring Meadows, Cotswold Hoburne, Cirencester, Gloucestershire.

DIRECTIONS

Please use the postcode GL7 5UQ or call the office at any time for detailed directions from your location.

SUMMARY

Occupying a corner plot on the desirable 'Meadows' part of this popular holiday park, this detached holiday home offers spacious accommodation which includes two bedrooms, an ensuite bathroom, a separate shower room, kitchen, and plenty of reception space which includes sitting and dining areas. There is south facing decking, allocated parking and access to a wide range of leisure facilities, both on site and beyond.

PROPERTY

The property is accessed via an entrance hall with storage cupboard. To the left is the dining area which leads into the triple aspect living room. The kitchen is fitted with a range of storage and appliances which includes a washing machine. The master bedroom benefits from a dressing area and has a full ensuite with suite comprising bath, wc, and wash basin. The second bedroom also benefits from built in storage as well as access to the 'Jack and Jill' shower room fitted with a suite comprising shower cubicle, wc, and wash basin.

GARDENS

The property benefits from a southerly facing deck and allocated parking. It also takes advantage of this luxurious development with plenty of communal gardens, as well as leisure amenities, to enjoy.

LOCATION

The property is located on the exclusive Cotswold Hoburne resort in the heart of the Cotswold Water Park. It enjoys an enviable corner plot in the Meadows part of the development. There is easy access to the facilities which include an impressive entertainment complex with childrens play area, bar, and restaurant, indoor and outdoor heated pools, boating and fishing lakes, adventure golf, tennis court, multi-use games area, adventure playground, amusement arcade, shop, and much more! It is located on the edge of South Cerney which is an attractive village with a further shops and popular pubs and is within easy reach of the many beautiful walks and leisure facilities that the Cotswold Water Park has to offer.

VIEWING

Viewing is available by appointment 7 days a week. Please call your local office to arrange.

AGENTS NOTE

We wish to inform prospective purchasers that we have prepared these sales particulars as a general guide. We have not carried out a survey, nor have we tested any services, appliances or any specific fittings at the property. Room sizes should not be relied upon for carpets and furnishings.

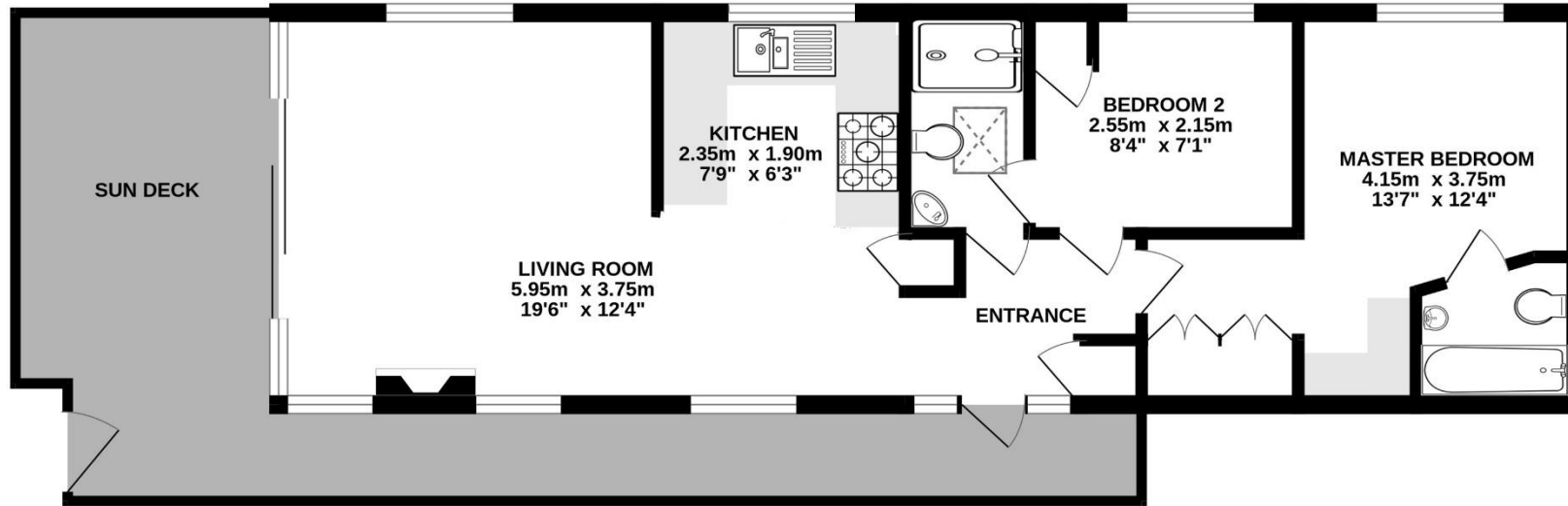

Whilst every attempt has been made to ensure the accuracy of the floorplan contained here, measurements of doors, windows, rooms and any other items are approximate and no responsibility is taken for any error, omission or mis-statement. This plan is for illustrative purposes only and should be used as such by any prospective purchaser. The services, systems and appliances shown have not been tested and no guarantee as to their operability or efficiency can be given.
 Made with Metropix ©2024



