







17 Willow View, Cotswold Hoburne,  
Cirencester, Gloucestershire.

### **DIRECTIONS**

Please use the postcode GL7 5UQ or call the office at any time for detailed directions from your location.

### **SUMMARY**

This is a superb opportunity to obtain a three bedroom holiday home with adjacent private parking on this popular development. It is surrounded by open areas and is conveniently located for all of the facilities on site. The accommodation includes three bedrooms, shower room and separate wc, kitchen, and attractive triple aspect living room with separate sitting and dining areas.



### **PROPERTY**

The property is accessed from the decking into the well equipped kitchen which has a range of storage and appliances which includes a dishwasher. Turning to the left takes you into the large, triple aspect living room with separate sitting and dining areas. The master bedroom is located at the other end of the property with built in wardrobe and there are two further twin bedrooms which also have built in storage. The family shower room is fitted with a suite comprising shower cubicle, wc, and wash hand basin, and there is a separate toilet with wc and wash hand basin as well.



### **GARDENS**

The property benefits from an adjacent parking space. There is a large, sunny area of decking as well as plenty of green areas to the side and behind. It also takes advantage of this luxurious development with plenty of communal gardens, as well as leisure amenities, to enjoy.

### **LOCATION**

The property benefits from an adjacent parking space. There is a large, westerly facing deck which has an enviable position looking over an area of green. It also takes advantage of this luxurious development with plenty of communal gardens, as well as leisure amenities, to enjoy.

### **VIEWING**

Viewing is available by appointment 7 days a week. Please call your local office to arrange.

### **AGENTS NOTE**

We wish to inform prospective purchasers that we have prepared these sales particulars as a general guide. We have not carried out a survey, nor have we tested any services, appliances or any specific fittings at the property. Room sizes should not be relied upon for carpets and furnishings.

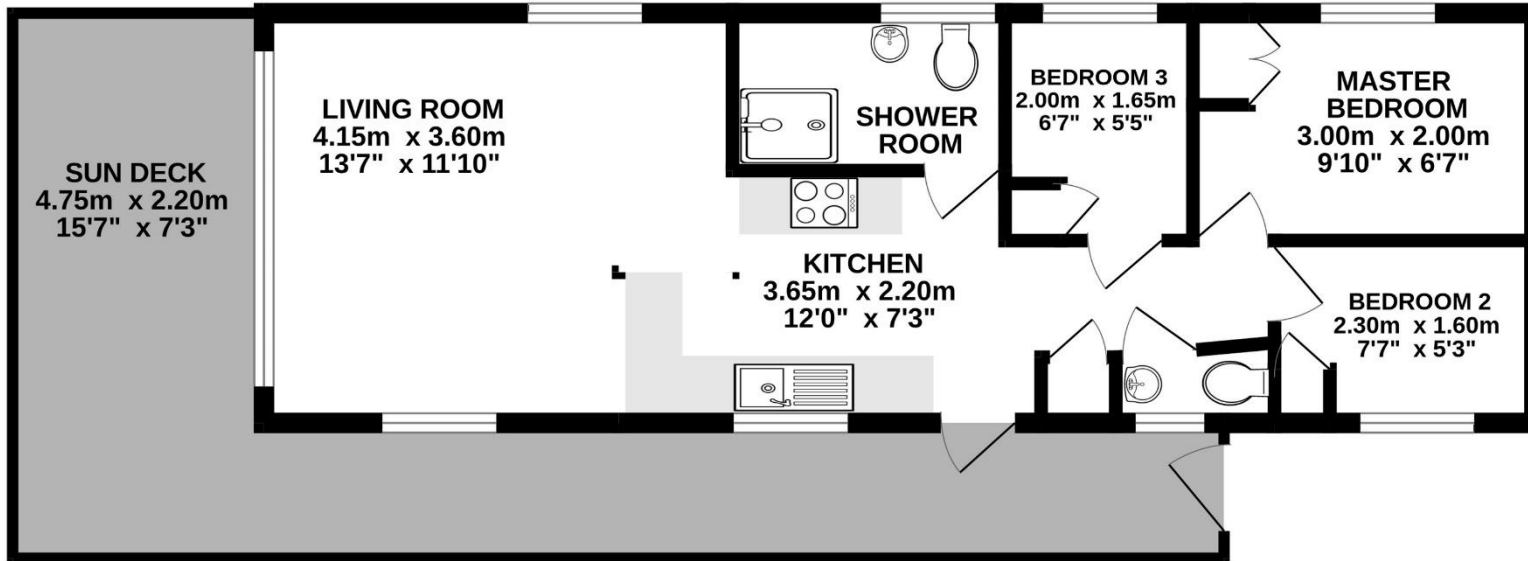

Whilst every attempt has been made to ensure the accuracy of the floorplan contained here, measurements of doors, windows, rooms and any other items are approximate and no responsibility is taken for any error, omission or mis-statement. This plan is for illustrative purposes only and should be used as such by any prospective purchaser. The services, systems and appliances shown have not been tested and no guarantee as to their operability or efficiency can be given.  
Made with Metropix ©2023





