



7 Broadway Drive, Cotswold Hoburne,
Cirencester, Gloucestershire.

DIRECTIONS

Please use the postcode GL7 5UQ or call the office at any time for detailed directions from your location.

SUMMARY

Detached holiday home located on this quiet close, but close to the amenities of this desirable development. The accommodation includes two bedrooms, shower room and ensuite wc, kitchen, sitting and dining areas. Further benefits of this high specification property include WiFi thermostat, adjoining parking and plenty of surrounding gardens.

PROPERTY

The property is accessed into a spacious kitchen/dining room. The kitchen is fitted with a range of storage and built in appliances. It is open to the living room which has double doors out to the decking.

The inner hall provides access to the two bedrooms and family shower room which is fitted with a suite comprising shower, wc and wash hand basin. Both bedrooms have built in storage whilst the master bedroom also benefits from an ensuite wc.

GARDENS

The property benefits from an adjoining parking space and a south westerly facing deck. It also takes advantage of this luxurious development with plenty of communal gardens, as well as leisure amenities, to enjoy.

LOCATION

The property is located on the exclusive Cotswold Hoburne resort in the heart of the Cotswold Water Park. Facilities include an impressive entertainment complex which include cafe, bar, and restaurant, indoor and outdoor heated pools, boating and fishing lakes, adventure golf, tennis court, multi-use games area, adventure playground, amusement arcade, shop, and much more! It is located on the edge of South Cerney which is an attractive village with a further shops and popular pubs and is within easy reach of the many beautiful walks and leisure facilities that the Cotswold Water Park has to offer.

VIEWING

Viewing is available by appointment 7 days a week. Please call your local office to arrange.

AGENTS NOTE

We wish to inform prospective purchasers that we have prepared these sales particulars as a general guide. We have not carried out a survey, nor have we tested any services, appliances or any specific fittings at the property. Room sizes should not be relied upon for carpets and furnishings.



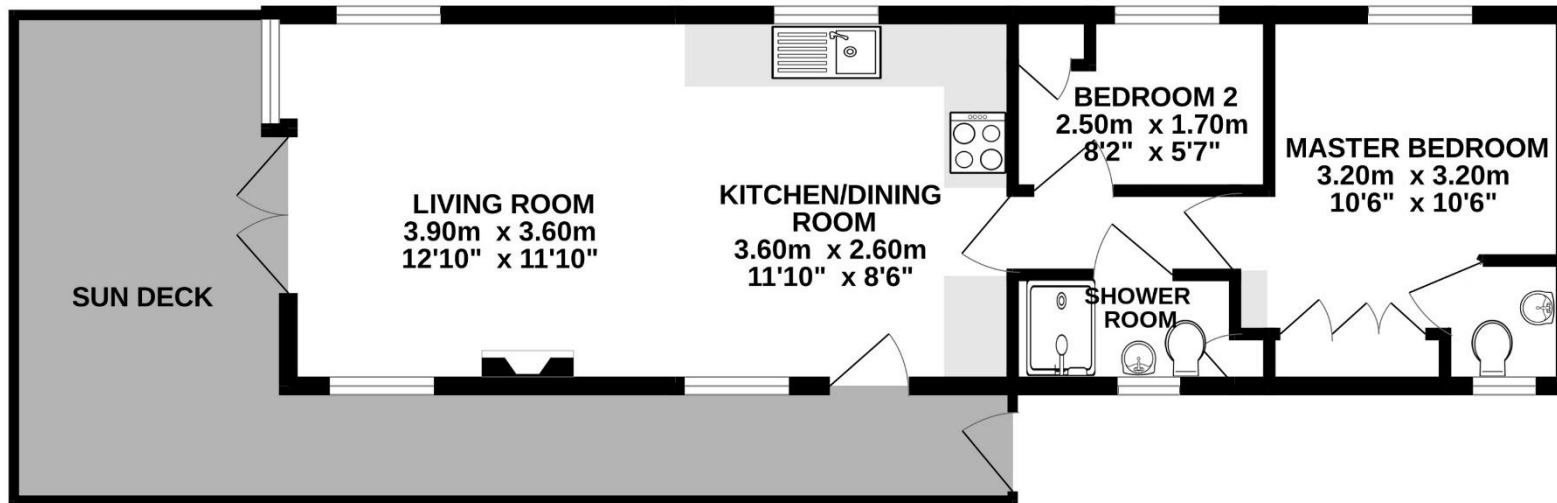

Whilst every attempt has been made to ensure the accuracy of the floorplan contained here, measurements of doors, windows, rooms and any other items are approximate and no responsibility is taken for any error, omission or mis-statement. This plan is for illustrative purposes only and should be used as such by any prospective purchaser. The services, systems and appliances shown have not been tested and no guarantee as to their operability or efficiency can be given.
Made with Metropix ©2023



