





6 Spring Meadow, Cotswold Hoburne, Cirencester, Gloucestershire.

DIRECTIONS

Please use the postcode GL7 5UQ or call the office at any time for detailed directions from your location.

SUMMARY

Three bedroom holiday home situated in a desirable position within this exclusive development. The property is well presented throughout and offers an excellent rental potential with a remaining 15 year term. Offered for sale with no onward chain and located in the heart of the Cotswold Water Park, this excellent property takes advantage of the many leisure facilities both on site, and beyond.

PROPERTY

The property is accessed into the well equipped kitchen/dining room which features a range of built in storage as well as appliances. This is open to the triple aspect living area with feature fireplace and double doors leading out to the decking. There is an internal hall which provides access to the three good size bedrooms which all have built in storage, the shower room with shower cubicle, wc, and wash hand basin, and finally the separate cloakroom with wc and wash hand basin.

GARDENS

The property benefits from allocated parking and an attractive area of decking as well as plenty of space around. It also takes advantage of this luxurious development with plenty of communal gardens, as well as leisure amenities, to enjoy.

LOCATION

The property is located on the exclusive Cotswold Hoburne resort in the heart of the Cotswold Water Park. Facilities include an impressive entertainment complex which include

cafe, bar, and restaurant, indoor and outdoor heated pools, boating and fishing lakes, adventure golf, tennis court, multi-use games area, adventure playground, amusement arcade, shop, and much more! It is located on the edge of South Cerney which is an attractive village with a further shops and popular pubs and is within easy reach of the many beautiful walks and leisure facilities that the Cotswold Water Park has to offer.

VIEWING

Viewing is available by appointment 7 days a week. Please call your local office to arrange.

AGENTS NOTE

We wish to inform prospective purchasers that we have prepared these sales particulars as a general guide. We have not carried out a survey, nor have we tested any services, appliances or any specific fittings at the property. Room sizes should not be relied upon for carpets and furnishings.



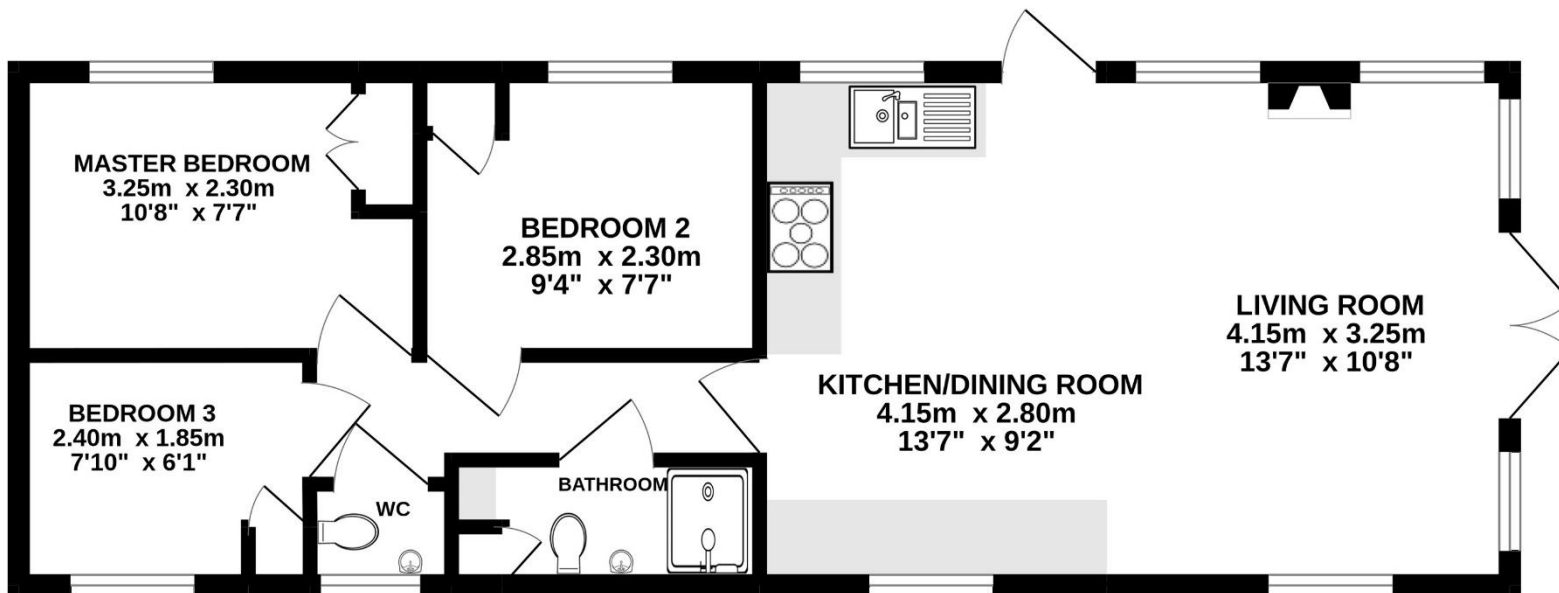

Whilst every attempt has been made to ensure the accuracy of the floorplan contained here, measurements of doors, windows, rooms and any other items are approximate and no responsibility is taken for any error, omission or mis-statement. This plan is for illustrative purposes only and should be used as such by any prospective purchaser. The services, systems and appliances shown have not been tested and no guarantee as to their operability or efficiency can be given.
Made with Metropix ©2022





cbslade
property group

01285 641839
cirencester@cbslade.co.uk

01793 752382
cricklade@cbslade.co.uk

www.cbslade.co.uk