

Arthur Court | London, SW11



Offers In Excess Of £185,000
Leasehold

• GUIDE PRICE £185,000-£210,000 • Purpose Built Flat • One Bedroom • Top Floor • Stunning Views • Masses of Natural Light • Short Walk to Battersea Park • Close to Battersea Power Station Tube • CASHBUYERS ONLY DUE TO LENDING RESTRICTIONS • No Chain

Arthur Court | London, SW11



GUIDE PRICE £185,000-£210,000. Top floor flat in purpose built block located in fantastic position moments away from the wide open spaces of Battersea Park, a short walk from Chelsea Bridge.

Comprises reception room leading into kitchen, double bedroom and bathroom.

The flat has masses of natural light and stunning views towards Battersea Power Station and the London skyline.

There's a Tesco Metro a stone's throw away and excellent transport links with both Queenstown Road and Battersea Park Stations within a few minutes walk (direct trains 11 minutes to Waterloo and 5 minutes to Victoria). The new Northern Line Tube Stop (Zone 1) is approx 12 minutes walk away and there are good bus routes into the West End and City.

Great choice of local shops, riverside bars, restaurants and coffee shops nearby.

Available to CASHBUYERS ONLY due to current lending restrictions. Off street residents parking permit on application. Wandsworth Council Tax Band A. Lease is 88 years, service charge approx £1,320/annum.

Available with no chain.

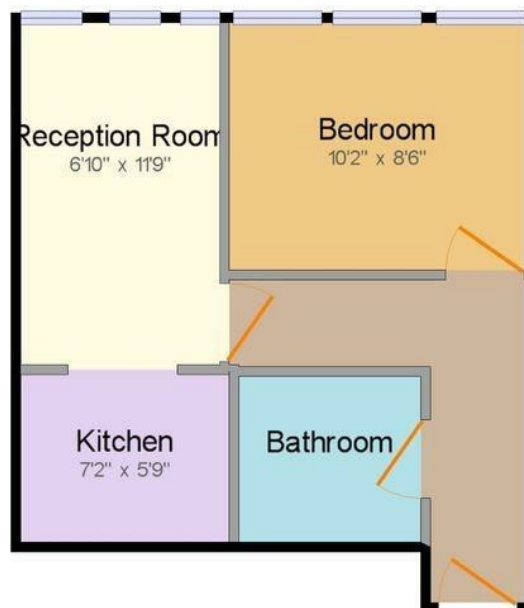

Tenth floor

Total approx floor area: 315.9 ft² (29.3 m²)
Tenth floor: 315.9 ft² (29.3 m²)

Energy Efficiency Rating		
	Current	Potential
Very energy efficient - lower running costs		
(92 plus) A		81
(81-91) B		
(69-80) C	73	
(55-68) D		
(39-54) E		
(21-38) F		
(1-20) G		
Not energy efficient - higher running costs		
England & Wales		EU Directive 2002/91/EC

These particulars are designed to provide a guideline only and cannot be relied upon as a statement of fact. The description represents the opinion of the author and is not intended to provide false or misleading information. Any prospective purchaser should make further checks on its accuracy. All measurements are approximate and floorplans are for representation only.



Eden Harper
64 Battersea Park Road, London, SW11 4JP
0207 720 1116
info@edenharper.com
www.edenharper.com