



Lurline Gardens | , SW11



Fantastic first floor period mansion flat located in superb setting close to the wide open spaces of Battersea Park, a short walk from Chelsea Bridge and Battersea Power Station with its extensive range of shopping, riverside bars, restaurants and coffee shops.

The accommodation is 452 sq ft and comprises reception room, separate kitchen, double bedroom and modern bathroom with shower. Features include high ceilings, sash windows and gas central heating.

Lurline gardens is a quiet residential road located just south of Chelsea Bridge and with excellent transport links with both Queenstown Road and Battersea Park Stations moments away and good bus services straight into Chelsea and the West End. The new Northern Line Tube Stop at Battersea Power Station is a 12 minute stroll away. Resident on-street parking permit available on application. Lease 166 years unexpired. Wandsworth Council Tax Band D. Superb first time buy or investment property, available with no chain.

- Period Mansion Flat
- First Floor
- One Bedroom
- Reception Room & Separate Kitchen
- Next to Battersea Park
- Excellent Transport Links
- Short Walk from Chelsea Bridge
- Quiet Residential Road
- 12 Minutes Walk to Battersea Power Station
- 166 Years Lease

Asking Price £450,000

Viewing

Please contact our Battersea Office on 0207 720 1116 if you wish to arrange a viewing appointment for this property or require further information.



**Albert Palace Mansions,
Lurline Gardens,
Battersea, SW11**

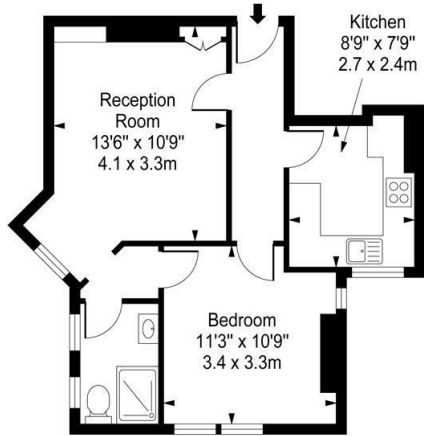

First Floor

Approx Gross Internal Area **452 Sq Ft - 42.0 Sq M**
For Illustration Purposes Only - Not To Scale
photosandfloorplans.com ©



Energy Efficiency Rating		Environmental Impact (CO ₂) Rating																													
Current	Potential	Current	Potential																												
Very energy efficient - lower running costs																															
Very environmentally friendly - lower CO ₂ emissions																															
<table border="0"> <tr> <td style="width: 25%;">(92 plus) A</td> <td style="width: 25%;"></td> <td style="width: 25%;">(82 plus) A</td> <td style="width: 25%;"></td> </tr> <tr> <td>(81-91) B</td> <td></td> <td>(81-91) B</td> <td></td> </tr> <tr> <td>(69-80) C</td> <td></td> <td>(69-80) C</td> <td></td> </tr> <tr> <td>(55-68) D</td> <td></td> <td>(55-68) D</td> <td></td> </tr> <tr> <td>(39-54) E</td> <td></td> <td>(39-54) E</td> <td></td> </tr> <tr> <td>(21-38) F</td> <td></td> <td>(21-38) F</td> <td></td> </tr> <tr> <td>(1-20) G</td> <td></td> <td>(1-20) G</td> <td></td> </tr> </table>				(92 plus) A		(82 plus) A		(81-91) B		(81-91) B		(69-80) C		(69-80) C		(55-68) D		(55-68) D		(39-54) E		(39-54) E		(21-38) F		(21-38) F		(1-20) G		(1-20) G	
(92 plus) A		(82 plus) A																													
(81-91) B		(81-91) B																													
(69-80) C		(69-80) C																													
(55-68) D		(55-68) D																													
(39-54) E		(39-54) E																													
(21-38) F		(21-38) F																													
(1-20) G		(1-20) G																													
79	82	70	75																												
Not energy efficient - higher running costs																															
Not environmentally friendly - higher CO ₂ emissions																															
England & Wales		England & Wales																													
EU Directive 2002/91/EC		EU Directive 2002/91/EC																													



These particulars, whilst believed to be accurate are set out as a general outline only for guidance and do not constitute any part of an offer or contract. Intending purchasers should not rely on them as statements of representation of fact, but must satisfy themselves by inspection or otherwise as to their accuracy. No person in this firm's employment has the authority to make or give any representation or warranty in respect of the property.