



## Chiswick High Road, London, W4 1SZ

A nicely presented one bedroom first floor apartment, conveniently located along Chiswick's main high road with its array of boutique shops and restaurants, main retailers include M&S, Waitrose, Sainsbury, Tesco & The Co-Op.

Accommodation provides: Kitchen/Living Room, large spacious double bedroom, modern shower room, gas, fired central heating, CPZ parking.

Local transport links include both Turnham Green & Stamford Brook tube stations, numerous local bus routes with convenient vehicular access via A4/M4 to central London, Heathrow & The West. Hounslow Council Band D. EPC-C. The property is offered unfurnished. Available 1st August

- Nicely presented apartment
- Close to all amenities
- Great for transport links
- Kitchen/living room
- Double bedroom
- Shower room
- CPZ parking
- Available 1st August
- Offered unfurnished

**£1,450 Per Calendar Month**

# Chiswick High Road, W4

Approximate gross internal area

38.46 sq m / 414 sq ft

Key :  
CH - Ceiling Height

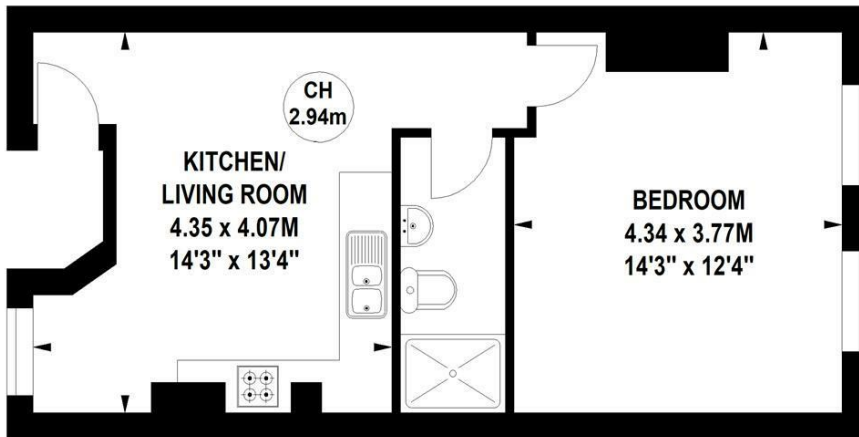

## First Floor

Not to scale, for guidance only and must not be relied upon as a statement of fact.  
All measurements and areas are approximate only

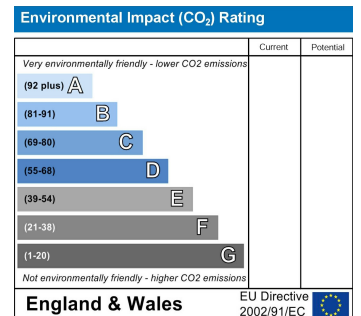
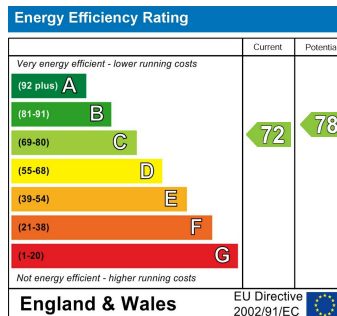

5-7 Turnham Green Terrace, Chiswick, London, W4 1RG

Tel 020 8747 8800

E-mail [lettings@whitmanandco.com](mailto:lettings@whitmanandco.com)

Website [www.whitmanandco.com](http://www.whitmanandco.com)