



Florence Road, Chiswick, W4 5DP

Guide Price £525,000

WHITMAN & CO.

SALES · LETTINGS · COMMERCIAL

- Two bedroom maisonette
- Private terrace
- No chain
- Private front door
- Fantastic transport links
- Share of Freehold

Tenure - Leasehold with Share of Freehold
 Lease length - 960 Years remaining
 Ground Rent - peppercorn
 Service Charge - £600 pa
 Local authority - Ealing
 Council tax - Band D

THE PROPERTY

A spacious and well-presented two-bedroom maisonette with a west-facing terrace, ideally located on a quiet, tree-lined residential street.

This charming property features two double bedrooms, a generous 13'11" reception room, a luxury bathroom, and a fully fitted kitchen/breakfast room leading onto the terrace. Additional benefits include a private front door, a 960-year lease, and a share of the freehold.

Conveniently situated close to numerous transport links. Offered with no onward chain.

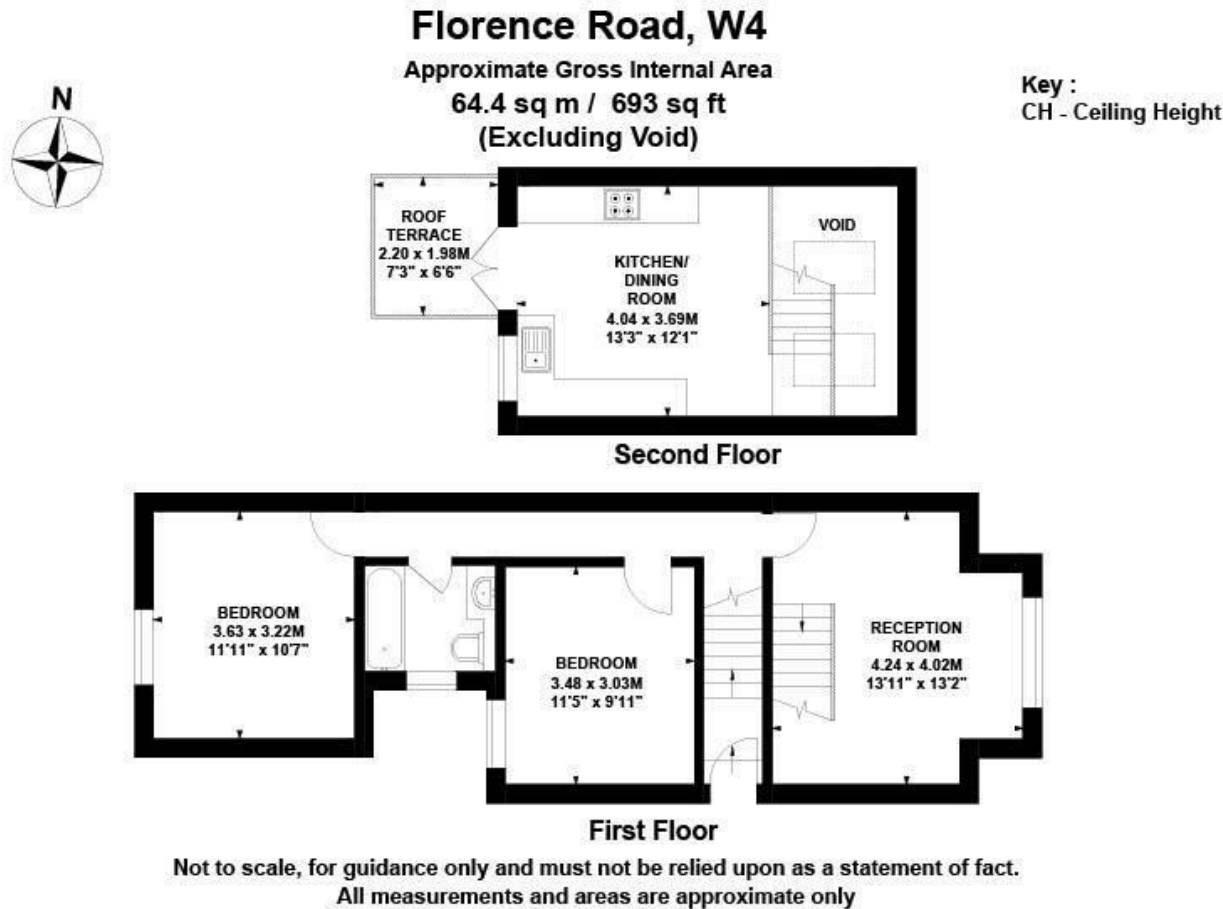

SITUATION



5-7 Turnham Green Terrace, Chiswick, London, W4 1RG

Tel 020 8747 8800

E-mail sales@whitmanandco.com

Website www.whitmanandco.com