



Courtfield, London, W4 3EQ

An immaculately presented two bedroomed apartment situated in this very popular residential location within the "Grove Park" area of Chiswick renowned for its open spaces including Chiswick House Grounds and Dukes meadows, whilst riverside walks and bars along the historic Strand on the green are within easy reach. Accommodation provides: 21 x 10'6" bright & spacious dual aspect reception room, modern fitted kitchen, master bedroom with full range of fitted wardrobes, luxury ensuite shower room and further bathroom, gas fired central heating, surrounding communal gardens, potential garage by separate negotiation. Local transport links include Chiswick mainline station to Waterloo, Chiswick Park and Turnham green tube stations via the underpass, numerous local bus routes with convenient vehicular access via A4/M4/A40 to Central London, Heathrow & The West. Hounslow Council Tax Band D. Wifi included. The property is offered furnished and available 24th June

- Lovely residential area
- Immaculately presented
- Great for transport links
- Large dual aspect reception room
- Modern fitted galley style kitchen
- Master bedroom with fitted wardrobes
- Second double bedroom
- Luxury family bathroom & further shower room
- Surrounding shared gardens
- The property is offered furnished and available 24th June

£2,200 Per Calendar Month

Courtfield, Sutton Court Road, Chiswick, W4

Approximate gross internal area

70.98 sq m / 764 sq ft



Key :
CH - Ceiling Height

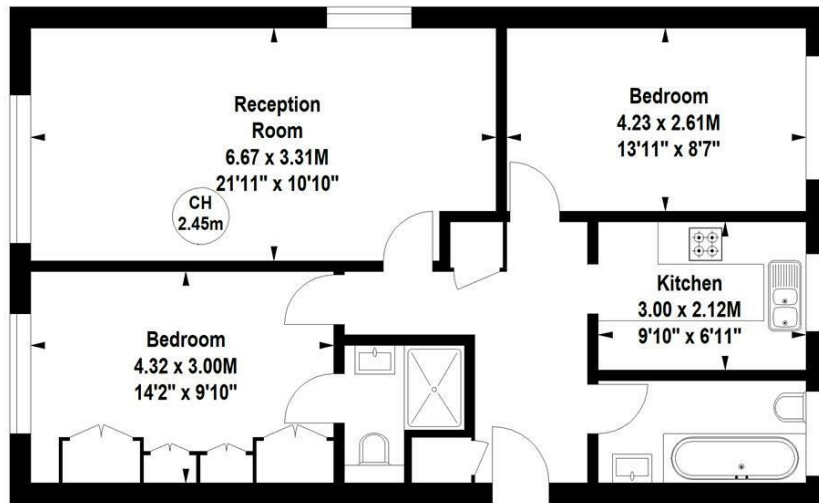

Second Floor

Not to scale, for guidance only and must not be relied upon as a statement of fact.
All measurements and areas are approximate only

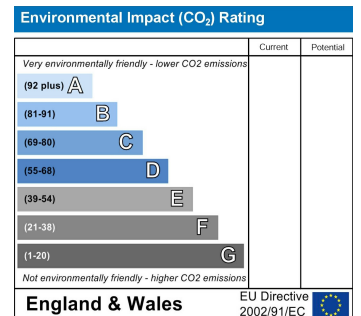
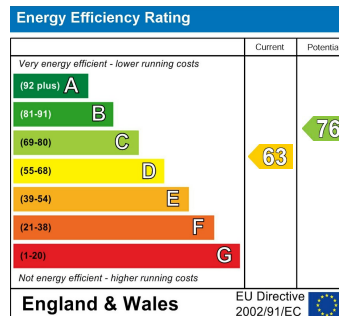

5-7 Turnham Green Terrace, Chiswick, London, W4 1RG

Tel 020 8747 8800

E-mail lettings@whitmanandco.com

Website www.whitmanandco.com