



Chiswick Staithe, London, W4 3TP

Guide Price £1,500,000

WHITMAN & CO.

SALES · LETTINGS · COMMERCIAL

- Riverfronting townhouse
- Garden with private jetty on the river
- Private development
- Incredible views along the Thames
- Excellent entertaining space
- Close to Chiswick Station

Tenure - Freehold
 Estate Charge - Approx. £1,300 pa
 Local Authority - Hounslow
 Council Tax - Band G

THE PROPERTY

A rarely available riverfront townhouse with a fabulous garden and private jetty over the Thames with incredible views from Chiswick Bridge across to Kew, located within this popular private development in the Grove Park area of Chiswick. Arranged over four floors totalling 2174 sqft with flexible living space the accommodation comprises three/four bedrooms, three bath/shower rooms (one ensuite), a fabulous 31'x16'6" first-floor reception room with balcony and river views, 32' kitchen/dining/family room which opens onto a private southwest facing garden with an incredible private jetty directly on the river, off street parking, utility room, extensive storage throughout, large loft and communal riverside gardens. Chiswick Staithe is well located for Dukes Meadows playing fields, Chiswick House and Grounds and local shops and pubs. Transport links include Chiswick mainline station (10-minute walk), local bus routes and the A4/M4 for routes in and out of London.

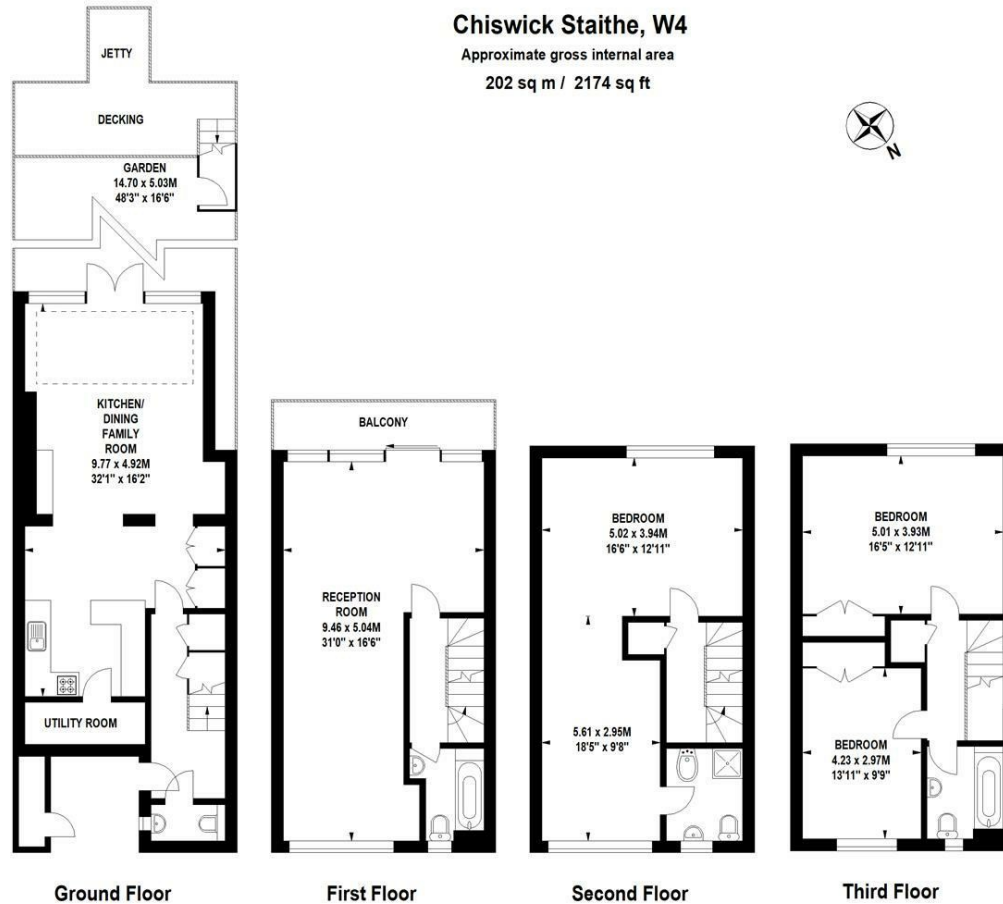

SITUATION



5-7 Turnham Green Terrace, Chiswick, London, W4 1RG

Tel 020 8747 8800

E-mail sales@whitmanandco.com

Website www.whitmanandco.com



MISREPRESENTATION ACT 1967

Whitman & Co. for themselves and for the vendors give notice that these particulars do not constitute any part of, an offer of contract. All statements contained in these particulars are made without responsibility on the part of Whitman & Co. or the vendor. None of the statements contained in these particulars is to be relied upon as statements or representations of facts. Any intending purchaser must satisfy himself by inspection or otherwise as to the correctness of each of the statements contained in these particulars. The vendor does not make or give, and neither Whitman & Co. or any person in their employment has any authority to make or give, any representation or warranty whatever in relation to the property.