



Vespan Road, W12 9QG

NEWLY DECORATED - An absolutely stunning, spacious and light three bed/two bath split-level apartment in this quiet street in the Shepherds Bush area offering close proximity to Westfield, numerous transport links and the popular shops, cafes and restaurants on Askew Road. The property comprises; three double bedrooms, two bathrooms, incredibly spacious open plan kitchen/reception room, extensive built in storage. Hammersmith & Fulham Band E. EPC-C. Available immediately and on an unfurnished basis.

- NEWLY DECORATED
- Spacious split level apartment
- 16' x 16' Reception room
- Roof terrace
- Three bedrooms
- Two bathrooms
- EPC - C
- Hammersmith and Fulham Council Tax Band E
- Available now

£3,000 Per Calendar Month

Vespan Road, W12
 Approx. Gross Internal Area
 989 Sq Ft - 91.88 Sq M

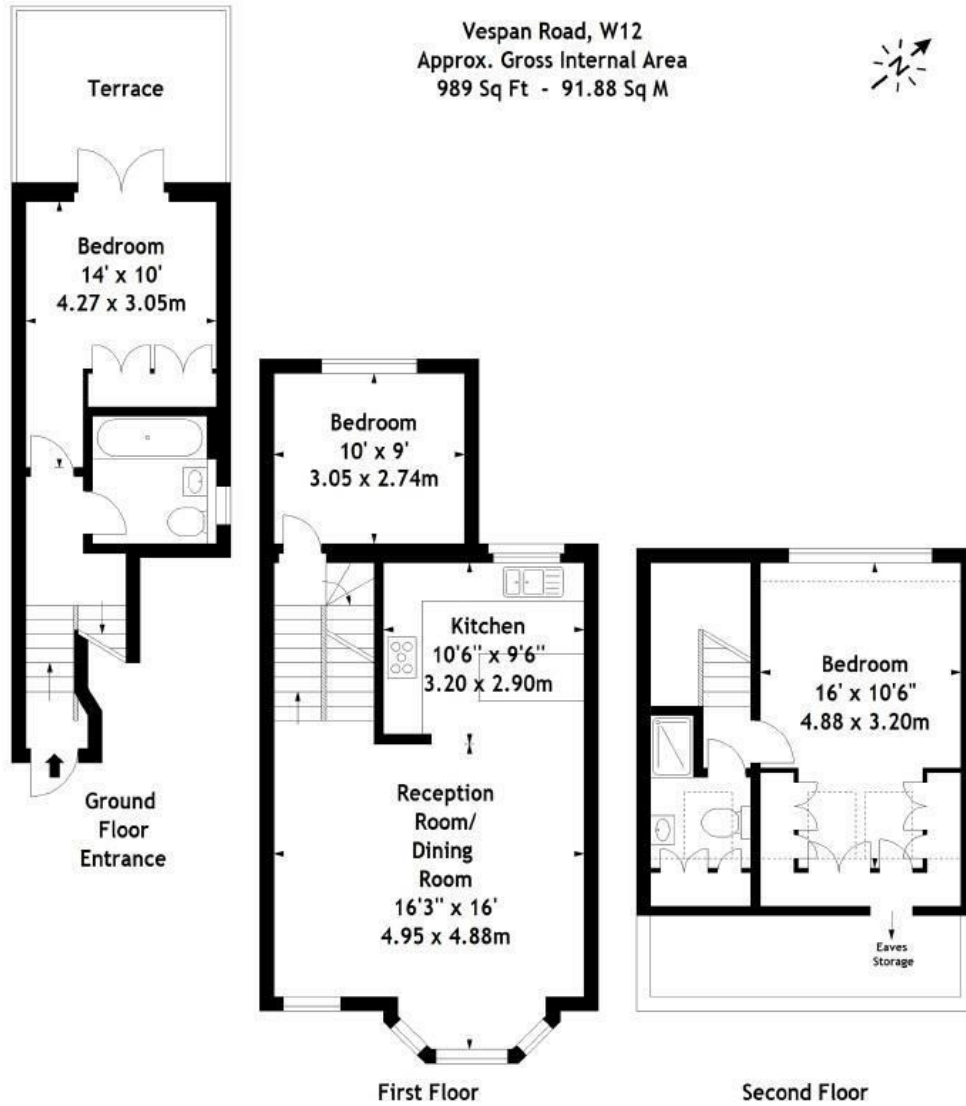

Measured in accordance with RICS guidelines. Every attempt is made to ensure accuracy, however all measurements are approximate. This floor plan is for illustrative purposes only and is not to scale.
 © Datography Ltd 2017
 Photographs * Floorplans * Virtual Tours
 Tel: 0845 643 4401 www.datography.com

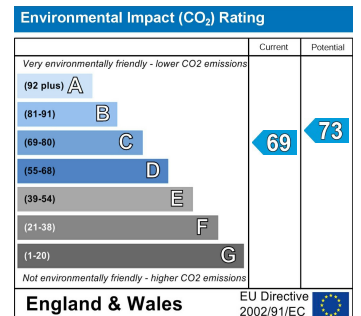
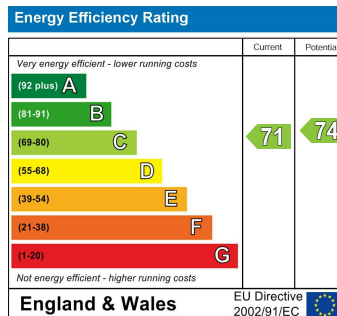

5-7 Turnham Green Terrace, Chiswick, London, W4 1RG
 Tel 020 8747 8800

PrimeLocation.com Zoopla.co.uk rightmove OnTheMarket.com

E-mail lettings@whitmanandco.com
 Website www.whitmanandco.com