



Weston Road, London, W4 5NH

Guide Price £500,000

**WHITMAN & CO.**

SALES · LETTINGS · COMMERCIAL

- Two-bedroom
- 13' Reception room
- Sought after location

- Private landscaped garden
- Excellent condition throughout
- Fantastic transport links

Tenure - Leasehold  
 Lease length - 180 Years remaining  
 Ground rent - £150 pa  
 Service charge - £250 pa  
 Local authority - Ealing  
 Council tax - Band C

## THE PROPERTY

A well-presented two-bedroom period conversion flat, ideally situated in this popular residential area, with the added benefit of a private landscaped garden. The property features a 13' reception room, two bedrooms, luxury bathroom, fitted integrated kitchen/breakfast room, long lease, and low outgoings, all in excellent condition throughout. Located in a tree-lined residential street, it offers close proximity to rail, tube, and bus networks, as well as the extensive range of shops, bars, and restaurants on Chiswick High Road.

## Weston Road, W4

Approximate gross internal area  
 57.51 sq m / 619 sq ft



Key :  
 CH - Ceiling Height

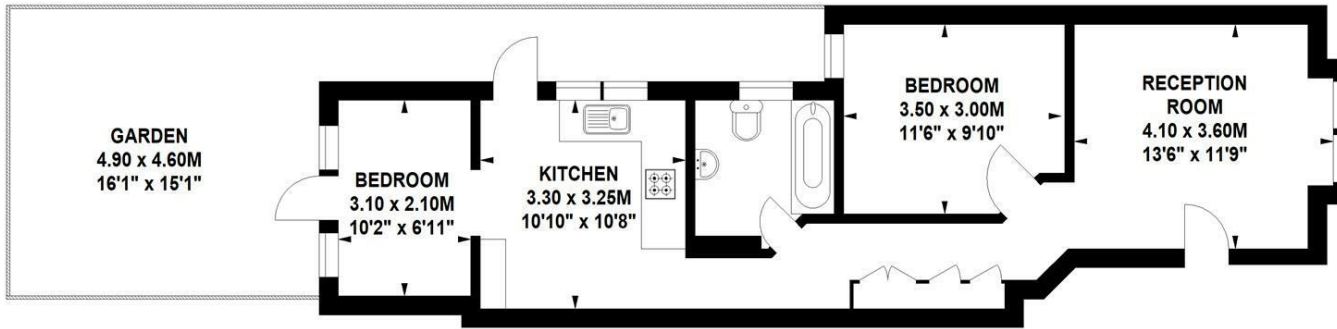

### Ground Floor

Not to scale, for guidance only and must not be relied upon as a statement of fact.  
 All measurements and areas are approximate only

## SITUATION

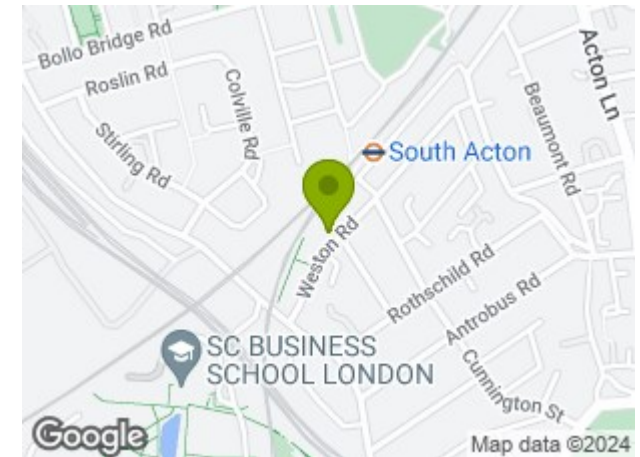

5-7 Turnham Green Terrace, Chiswick, London, W4 1RG

Tel 020 8747 8800

E-mail sales@whitmanandco.com

Website www.whitmanandco.com

