



Weston Road, London, W4 5NH

Guide Price £525,000

WHITMAN & CO.

SALES · LETTINGS · COMMERCIAL

- Two-bedroom
- 13' Reception room
- Sought after location

- Private landscaped garden
- Excellent condition throughout
- Fantastic transport links

Tenure - Leasehold
 Lease length - 180 Years remaining
 Ground rent - £150 pa
 Service charge - TBC
 Local authority - Ealing
 Council tax - Band C

THE PROPERTY

A well-presented two-bedroom period conversion flat, ideally situated in this popular residential area, with the added benefit of a private landscaped garden. The property features a 13' reception room, two bedrooms, luxury bathroom, fitted integrated kitchen/breakfast room, long lease, and low outgoings, all in excellent condition throughout. Located in a tree-lined residential street, it offers close proximity to rail, tube, and bus networks, as well as the extensive range of shops, bars, and restaurants on Chiswick High Road.

Weston Road, W4

Approximate gross internal area
 57.51 sq m / 619 sq ft



Key :
 CH - Ceiling Height

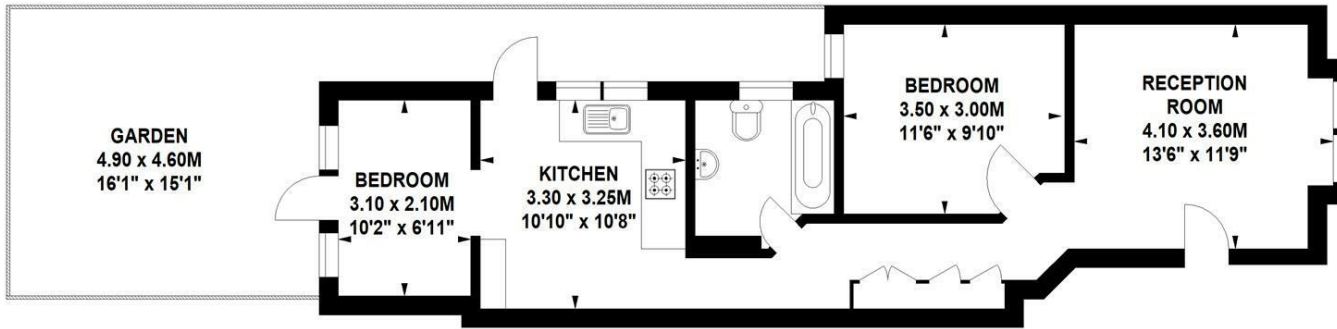

Ground Floor

Not to scale, for guidance only and must not be relied upon as a statement of fact.
 All measurements and areas are approximate only

SITUATION

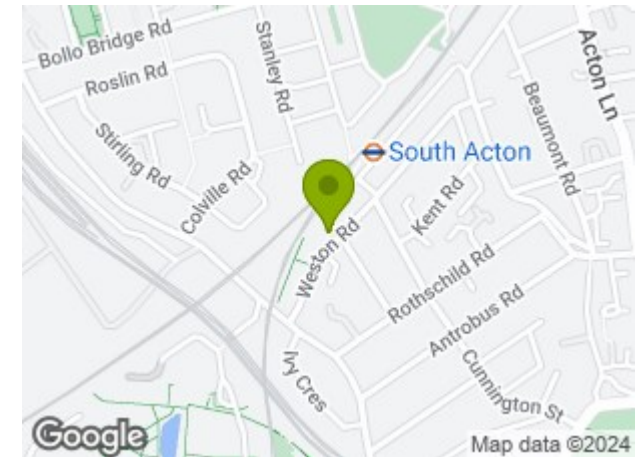

5-7 Turnham Green Terrace, Chiswick, London, W4 1RG

Tel 020 8747 8800

E-mail sales@whitmanandco.com

Website www.whitmanandco.com

