



Foster Road, London, W4 4NY

Guide Price £2,750,000

**WHITMAN & CO.**

SALES · LETTINGS · COMMERCIAL



- Six bedroom
- Semi-detached
- Private 57' landscaped garden
- Imposing hallway
- Sought after location
- Host of original features

Tenure - Freehold  
Local Authority - Hounslow  
Council Tax - Band G

## THE PROPERTY

An exceptional six bedroom semi-detached period house with imposing hallway and an excellent balance of living and entertaining space in this sought after residential street moments from Chiswick High Road. This fantastic house comprises a master suite, four/five further bedrooms, family bathroom, utility room, large entrance hall, two reception rooms, fully fitted kitchen, conservatory, cloakroom and private 57'5 landscaped garden with side access. Ideally located within close proximity of Turnham Green tube station and the extensive range of shops, bars and restaurants on Chiswick High Road.

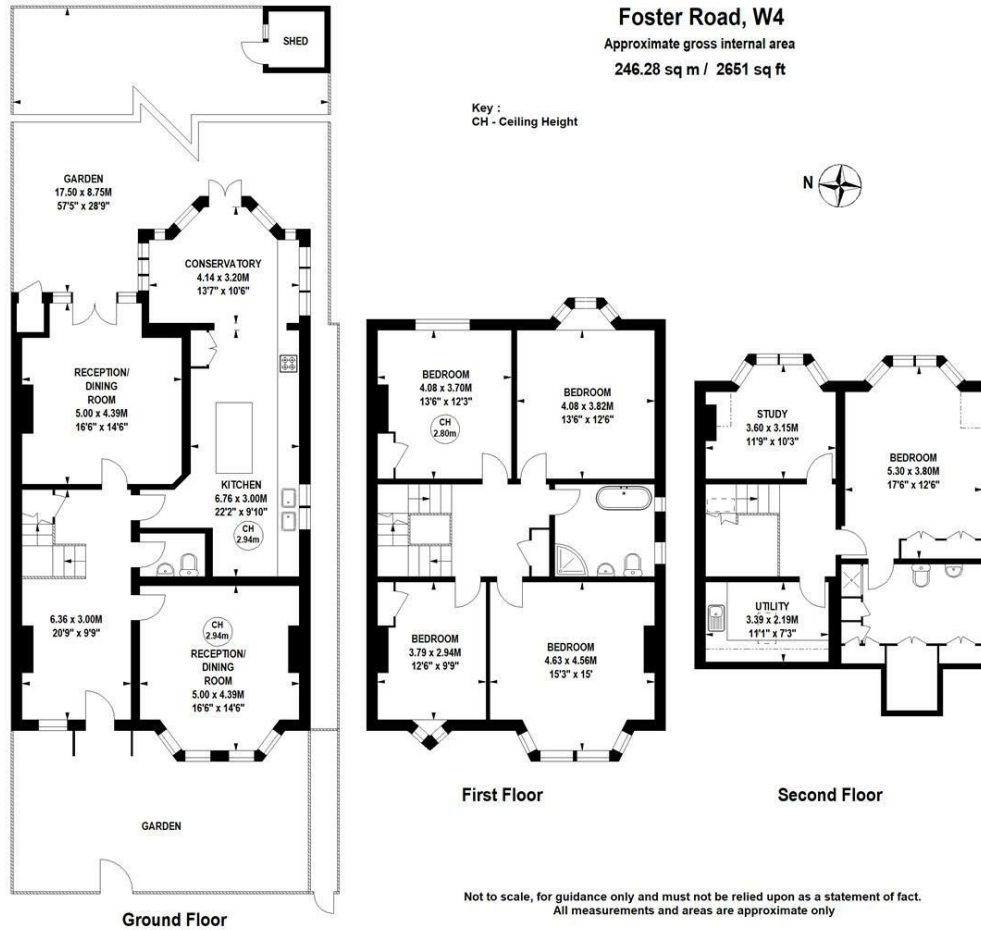

## SITUATION



5-7 Turnham Green Terrace, Chiswick, London, W4 1RG

Tel 020 8747 8800

E-mail [sales@whitmanandco.com](mailto:sales@whitmanandco.com)

Website [www.whitmanandco.com](http://www.whitmanandco.com)