

Bath Road, London, W4 1LL

£1,699,500

WHITMAN & CO.

SALES · LETTINGS · COMMERCIAL

- Stunning detached former Artist's studio
- Private 53'x34'3 landscaped garden
- Moments from Turnham Green station
- Spectacular 6.37m vaulted reception room
- Freehold property
- No onward chain

Tenure - Freehold
Local authority - Hounslow
Council tax - Band E

THE PROPERTY

A stunning detached former Artist's studio with a spectacular vaulted reception room and large private garden located a stone's throw from Chiswick High Road's shops, cafes and restaurants. This is an incredibly rare opportunity to buy one of a small number of Artist's studios within the sought-after Bedford Park Conservation Area. Set back from Bath Road and surrounded by mature gardens, the accommodation comprises a 28'3x19'9 reception/dining room with double-height ceilings and huge windows, fitted kitchen, two galleried double bedrooms overlooking the living space, ensuite shower room, family bathroom, stunning and private 53'x34'3 landscaped garden with side access, entrance hall, excellent built-in storage. The house is very well located for Chiswick High Road's shops, cafes and restaurants along with the independent retailers on Turnham Green Terrace. Transport links include Turnham Green station (2 min walk), local bus routes and the A4/M4 for routes in and out of London. No onward chain.

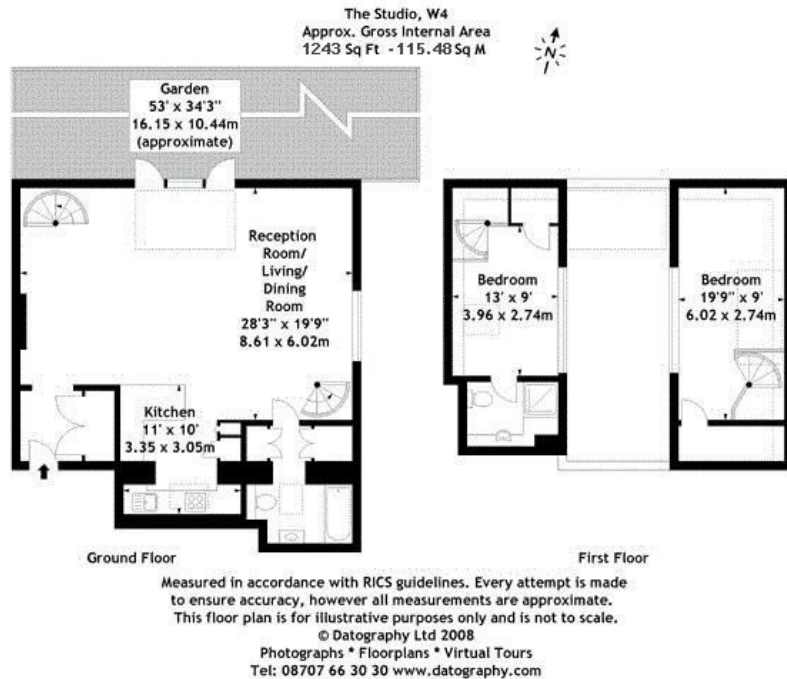

SITUATION



5-7 Turnham Green Terrace, Chiswick, London, W4 1RG

Tel 020 8747 8800

E-mail sales@whitmanandco.com

Website www.whitmanandco.com