



## Oxford Gardens, London, W4 3BN

A beautifully presented one-bedroomed garden flat situated in this popular residential cul-de-sac within walking distance of Chiswick High Road with its array of boutique shops and restaurants, retailers include M&S, Waitrose, Sainsbury & Tesco. Within close proximity to the river Thames with its riverside walks, historic pubs, and eating houses. The accommodation provides: a spacious main front reception room with a feature fireplace and plantation shutters, a double bedroom, bathroom, fully fitted kitchen/dining room with doors leading to a south-facing landscaped rear garden with rear access, gas fired central heating, CPZ parking. Local transport links include both Chiswick park & Gunnersbury tube stations, Kew Bridge mainline station, Numerous local bus routes with convenient vehicular access via A4/M4. Hounslow Council Band D. EPC-D. The property is offered as part furnished and available 31st May.

- Beautifully presented Garden Flat
- Cul-de-sac location
- Great for transport links
- Spacious reception room
- Fitted kitchen/dining room
- Double bedroom
- Spacious bathroom
- Southerly aspect landscaped garden
- Available 31st May
- Part Furnished

**£1,900 Per Calendar Month**

# Oxford Gardens, W4

Approximate gross internal area  
54.44 sq m / 586 sq ft



Key :  
CH - Ceiling Height

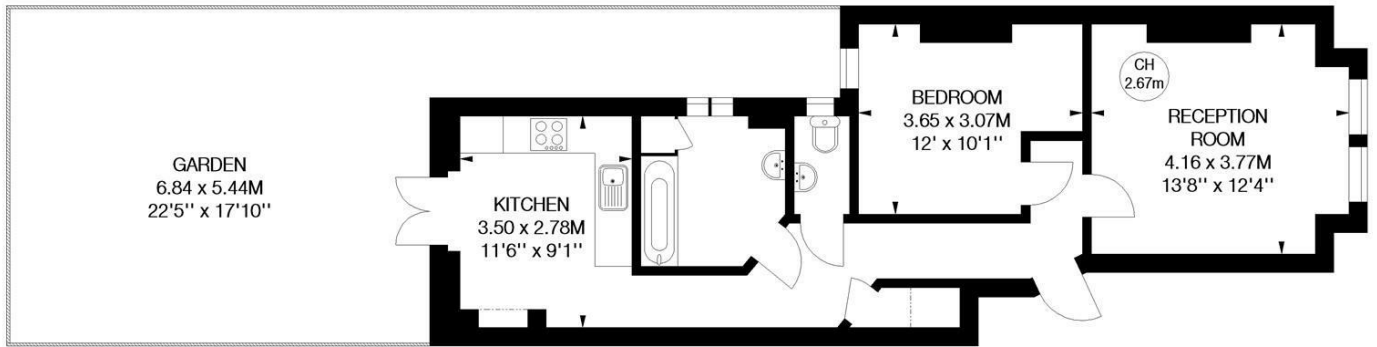

## Ground Floor

Not to scale, for guidance only and must not be relied upon as a statement of fact.  
All measurements and areas are approximate only

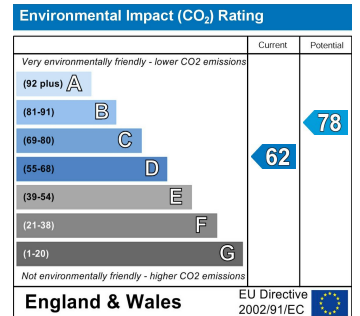
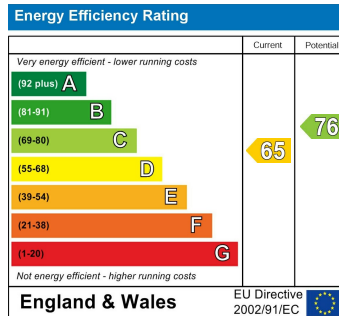

5-7 Turnham Green Terrace, Chiswick, London, W4 1RG  
Tel 020 8747 8800

E-mail [lettings@whitmanandco.com](mailto:lettings@whitmanandco.com)  
Website [www.whitmanandco.com](http://www.whitmanandco.com)