



Watchfield Court, London, W4 4NE

Guide Price £325,000

WHITMAN & CO.

SALES · LETTINGS · COMMERCIAL

- Unmodernised second floor apartment
- Lift access
- Close to numerous amenities
- Popular 1930s mansion block
- Communal gardens and off street parking
- No onward chain

Tenure - Leasehold with Share of Freehold
 Lease length - 170 Years remaining
 Ground Rent - peppercorn
 Service Charge - £4119 pa
 Local authority - Hounslow
 Council tax - Band D

Watchfield Court, Sutton Court Road, W4

Approximate gross internal area
39.20 sq m / 422 sq ft



THE PROPERTY

An unmodernised second floor one bedroom apartment set within this popular 1930s mansion block in central Chiswick. The flat requires full updating throughout, so provides a great opportunity for the purchaser to finish to their own taste. The accommodation comprises a double bedroom, reception room, separate kitchen, bathroom, lift access, communal gardens, porter/estate manager, and ample unallocated off-street parking. Watchfield Court is located just off Turnham Green offering close proximity to Chiswick High Road's extensive facilities. Transport links include Chiswick Park station, local bus routes and the A4/M4 for routes in and out of London. No onward chain.

SITUATION



Key :
 CH - Ceiling Height

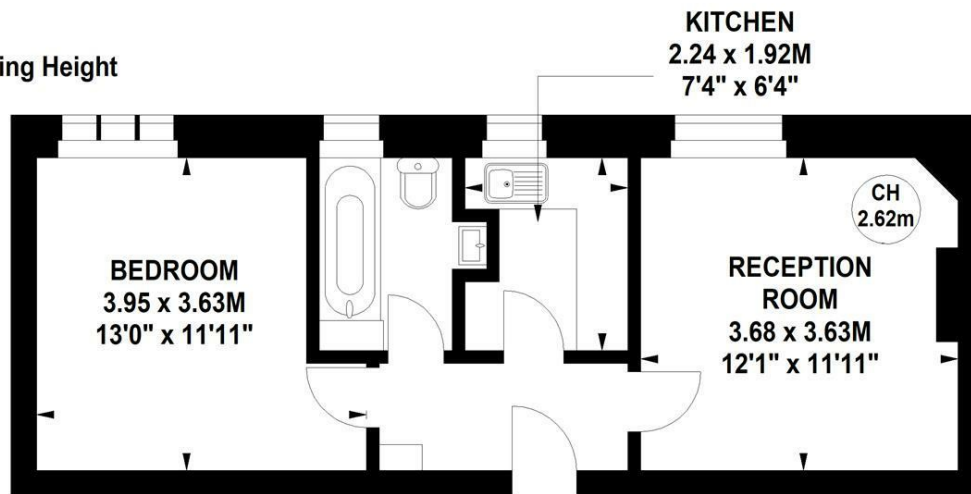

Second Floor

Not to scale, for guidance only and must not be relied upon as a statement of fact.
 All measurements and areas are approximate only

5-7 Turnham Green Terrace, Chiswick, London, W4 1RG

Tel 020 8747 8800

E-mail sales@whitmanandco.com

Website www.whitmanandco.com



MISREPRESENTATION ACT 1967

Whitman & Co. for themselves and for the vendors give notice that these particulars do not constitute any part of, an offer of contract. All statements contained in these particulars are made without responsibility on the part of Whitman & Co. or the vendor. None of the statements contained in these particulars is to be relied upon as statements or representations of facts. Any intending purchaser must satisfy himself by inspection or otherwise as to the correctness of each of the statements contained in these particulars. The vendor does not make or give, and neither Whitman & Co. or any person in their employment has any authority to make or give, any representation or warranty whatever in relation to the property.