

Throstle Row, Knottingley



£110,000



3



1



1



75

Located on Throstle Row, Knottingley, this delightful mid-terrace house presents an excellent opportunity for families and first-time buyers alike. One of the standout features of this residence is the off-street parking available at the rear, providing convenience and peace of mind in this bustling neighbourhood. Additionally, the property is complemented by good-sized gardens both at the front and rear, offering a wonderful outdoor space for gardening, play, or simply enjoying the fresh air. This home is not only practical but also offers a warm and welcoming atmosphere, making it a perfect canvas for personal touches. With its spacious rooms and outdoor areas, this mid-terrace house is a rare find in Knottingley, combining comfort with functionality. Do not miss the chance to make this lovely property your own.



- Spacious 3 bedroom town house
- Good size reception hall
- Large front facing lounge
- Well fitted dining kitchen, with range style cooker, and granite work surfaces
- Two good sized double bedrooms, one with fitted wardrobe
- Good sized single with custom built bunk bed
- Gardens to front and rear, with parking space
- No upper chain - IDEAL; FOR FIRST TIME BUYERS
- Council tax band A
- EPC Grade to follow

Call **01977 285 111** to view this property or visit www.crownestateagents.com

Opening hours:
Mon - Fri 9am - 5pm
Sat 10am - 2pm

Entrance hall

14'3" x 6'2" (4.36 x 1.88)

Good size reception area with panel and glazed door, Central heating radiator, useful under stairs store off and staircase to the first floor.

Lounge

13'11" x 11'11" (4.26 x 3.64)

Generous size reception room with wide front facing window, giving ample natural light, Central heating radiator.

Dining Kitchen

16'10" x 10'5" (5.14 x 3.18)

Fitted with a range of quality units including base cupboards and drawers, with granite work surfaces over, inset sink bowl, with wall units, wide slot in range cooker with seven ring gas hob and chimney style extractor hood over. Plumbing for automatic washing machine. breakfast bar, two rear facing windows and half glazed door to garden.

First floor landing

8'10" x 6'2" (2.71 x 1.88)

With loft ladder access to the roof, which has some boarding. Useful storage cupboard.

Bedroom 1

12'1" x 10'8" (3.70 x 3.26)

Great sized double with wide front facing window, and central heating radiator.

Bedroom 2

11'11" x 10'1" inc robes (3.64 x 3.08 inc robes)

Good sized double bedroom with rear facing window, and wardrobe/storage cupboard off housing the gas central heating boiler.

Bedroom 3

9'4" x 7'10" (2.87 x 2.39)

Good size single bedroom with custom built child's bunk bed, with storage below, front facing window, and central heating radiator.

Bathroom

8'2" x 5'4" (2.5 x 1.64)

Well presented modern bathroom, with white suite of panel bath, pedestal wash basin, and low flush WC. Tiled walls, chrome heated towel rail, and two rear facing windows.

External

To the front of the property, is an enclosed garden, mainly of lawn with a flagged footway to the property. At the rear of the property, there is a stoned chipping covered area of garden, and concrete parking space. Inbuilt storage cupboard.



Floor Plan

GROUND FLOOR
451 sq.ft. (41.9 sq.m.) approx.



1ST FLOOR
459 sq.ft. (42.7 sq.m.) approx.

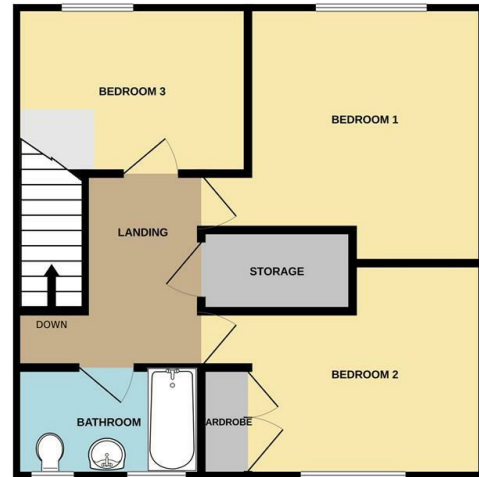

TOTAL FLOOR AREA: 910 sq.ft. (84.6 sq.m.) approx.

Whilst every attempt has been made to ensure the accuracy of the floorplan contained here, measurements of doors, windows, rooms and any other items are approximate and no responsibility is taken for any error, omission or mis-statement. This plan is for illustrative purposes only and should be used as such by any prospective purchaser. The services, systems and appliances shown have not been tested and no guarantee as to their operability or efficiency can be given.
Made with Metropix ©2025



Energy Efficiency Rating

	Current	Potential
Very energy efficient - lower running costs		
(92 plus) A		
(81-91) B		
(69-80) C		
(55-68) D		
(39-54) E		
(21-38) F		
(1-20) G		
Not energy efficient - higher running costs		
	75	86
England & Wales	EU Directive 2002/91/EC 	

Please call our Castle Dwellings Ltd Office on 01977 285 111 if you wish to arrange a viewing appointment for this property or if you require further information.

These particulars, whilst believed to be accurate are set out as a general outline only for guidance and do not constitute any part of an offer or contract. Intending purchasers should not rely on them as statements of representation of fact, but must satisfy themselves by inspection or otherwise as to their accuracy. No person in this firm's employment has the authority to make or give any representation or warranty in respect of the property.

Call 01977 285 111 to view this property or visit www.crownestateagents.com

Opening hours:
Mon - Fri 9am - 5pm
Sat 10am - 2pm

Crown Estate Agents: 39-41 Ropergate, Pontefract WF8 1JY & 22 Bank Street, Castleford WF10 1JD.  **CASTLE DWELLINGS**