



**Brightest**move

CLAREMONT CRESCENT  
WESTON-SUPER-MARE  
RENT £1,395 PCM





GROUND FLOOR

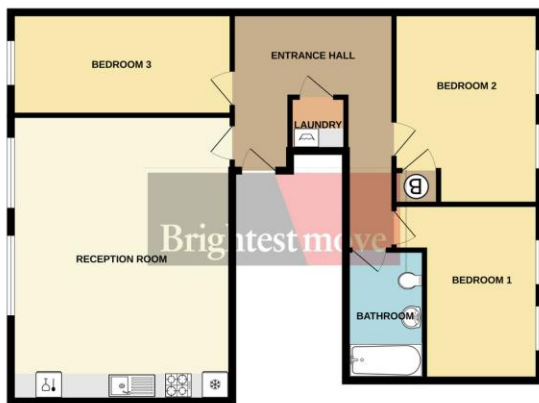

We have made every effort to ensure the accuracy of the floor plan information. Measurements of rooms, features, views and any other information are for guidance only and should not be relied upon for any purpose. The actual layout, features and measurements may vary from the information shown on the plan. We accept no liability for any errors or omissions. Please refer to the property details for more information.

We are delighted to offer this new renovation set on Weston Seafront providing excellent access to local shops and restaurants. The property briefly comprises Open Plan Lounge/Kitchen with panoramic sea views , Three Bedrooms and Bathroom. Further benefits include Electric Heating, Dishwasher, Washing Machine and Fridge/Freezer. Book Early to avoid Disappointment. AVAILABLE NOW. EPC D

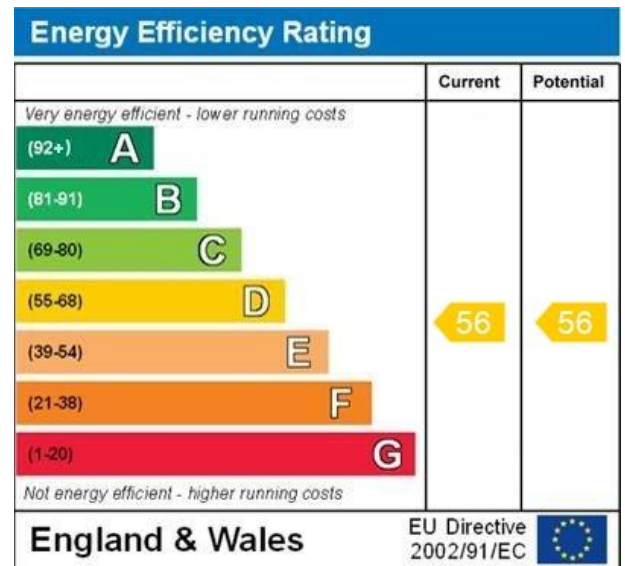

WWW.EPC4U.COM