



23 ASH CLOSE

BRISTOL, BS37 5TP

£975 PCM

- * Ground Floor Apartment
- * One Double Bedroom
- * Garden & Off Street Parking
- * Lounge/Diner and Conservatory
- * Bathroom and Further Cloakroom
- * Popular Cul-De-Sac Location
- * Available 1st Feb
- * No Pets, Smokers



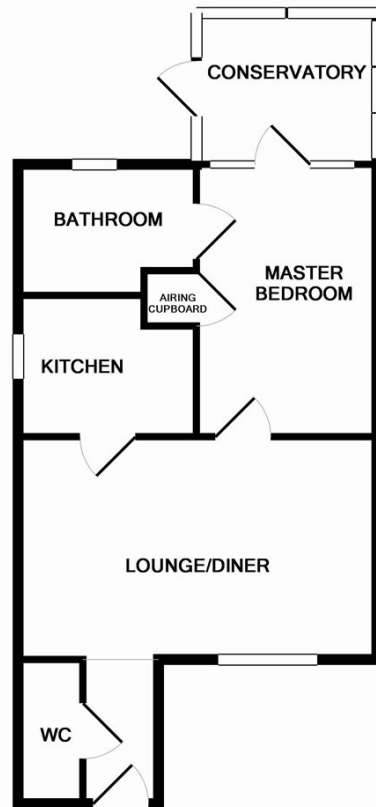

Measurements are approximate. Not to scale. Illustrative purposes only
Made with Metropix ©2016

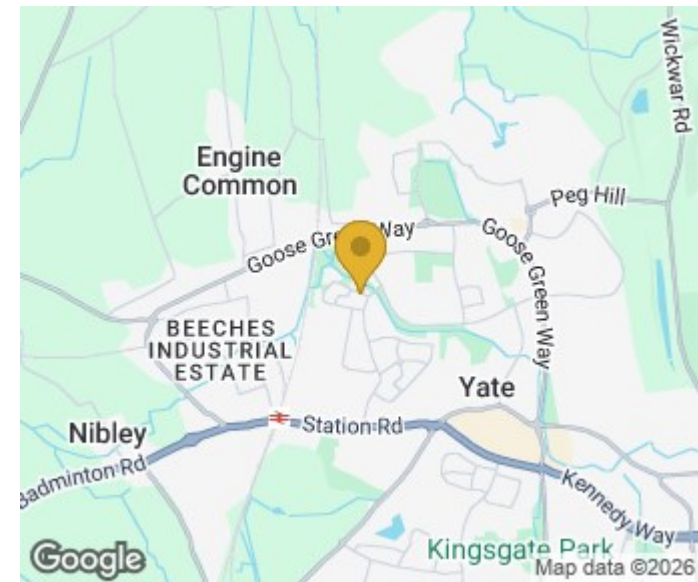

Energy Efficiency Rating		
	Current	Potential
Very energy efficient - lower running costs		
(92 plus) A		
(81-91) B		
(69-80) C		75
(55-68) D	55	
(39-54) E		
(21-38) F		
(1-20) G		
Not energy efficient - higher running costs		
England & Wales		EU Directive 2002/91/EC



4 Flaxpits Lane
Winterbourne
Bristol
Avon
BS36 1JX

01454 252140
info@aj-homes.co.uk
<https://www.aj-homes.co.uk>

Agents Note: Whilst every care has been taken to prepare these particulars, they are for guidance purposes only. All measurements are approximate and are for general guidance purposes only and whilst every care has been taken to ensure their accuracy, they should not be relied upon and potential buyers/tenants are advised to recheck the measurements