



School Road
Bristol BS30 8EN

Price:
£185,000

Property Features

- Purpose Built Apartment
- One Bedroom
- Excellent Condition
- Gas Central Heating
- Off Street Parking
- Close to Local Amenities
- Great Investment



Full Description

Hallway

Entrance hallway with boiler cupboard with wall mounted combi boiler, radiator, wood flooring and doors to;

Living Room

18'7" x 9'5"

Double glazed windows to front, two radiators, TV and telephone points, wood flooring, intercom system to front door and open to;

Kitchen

A range of wall and base units with work surface over, integrated oven and gas hob with extractor over, space for fridge freezer, space for washing machine, stainless steel sink with drainer and mixer tap, tiled splashbacks spotlights and wood flooring.

Bedroom

12'7" x 9'5" min

Double glazed window to front, radiator and TV point.

Bathroom

Newly fitted bathroom with panelled bath and mixer tap and main's shower over. Low-level WC, hand wash basin with mixer tap and splashback. Tiled floor and heated towel rail, spotlights and extractor fan.

Off street parking for one car.



GROUND FLOOR

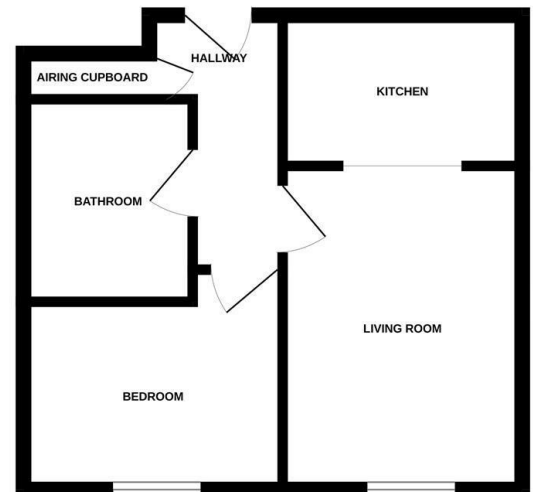

Measurements are approximate. Not to scale. Illustrative purposes only.
Made with Metropix C1025

4 Flaxpits Lane
Winterbourne
Bristol
BS36 1JX

www.aj-homes.co.uk
info@aj-homes.co.uk
01454 252140

Agents Note: Whilst every care has been taken to prepare these sales particulars, they are for guidance purposes only. All measurements are approximate are for general guidance purposes only and whilst every care has been taken to ensure their accuracy, they should not be relied upon and potential buyers are advised to recheck the measurements