



Stirling Close
Bristol. BS37 5UH

Price:
£1,350 PCM

Property Features

- * Two Double Bedrooms
- * Popular Cul-De-Sac Location
- * Garage & Off Street Parking
- * Unfurnished (with white goods)
- * 16ft Lounge
- * Separate Office Space
- * Available 13th June 2025
- * No Pets, Sharers or Smokers



Full Description

LOUNGE

16'8" x 11'8"

Fireplace, 2 x electric storage heaters

KITCHEN/DINING ROOM

11'8" x 11'8"

With some white goods

OFFICE / STORAGE ROOM

11'2" x 7'7"

French doors to garden, personnel door to garage.

BEDROOM 1

11'8" x 9'3"

Electric storage heater

BEDROOM 2

11'8" x 8'1"

Electric storage heater

BATHROOM

8'6" x 4'10"

Bath with shower over, basin and wc

GARAGE

PARKING

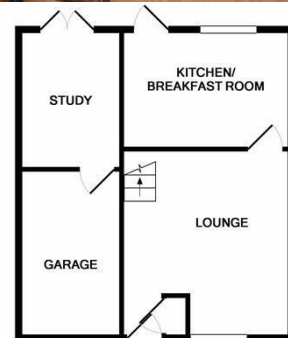

GROUND FLOOR

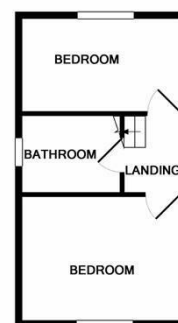

1ST FLOOR

Whilst every attempt has been made to ensure the accuracy of the floor plan contained here, measurements of doors, windows, rooms and any other items are approximate and no responsibility is taken for any error, omission, or mis-statement. This plan is for illustrative purposes only and should be used as such by any prospective purchaser. The services, systems and appliances shown have not been tested and no guarantee as to their operability or efficiency can be given.
Made with Metropix 5/2013

4 Flaxpits Lane
Winterbourne
Bristol
BS36 1JX

www.aj-homes.co.uk
info@aj-homes.co.uk
01454 252140

Agents Note: Whilst every care has been taken to prepare these sales particulars, they are for guidance purposes only. All measurements are approximate are for general guidance purposes only and whilst every care has been taken to ensure their accuracy, they should not be relied upon and potential buyers are advised to recheck the measurements