



Cheshire Close
BRISTOL BS37 5TQ

Price:
£1,300 PCM

Property Features

- Three Bedrooms
- Mid Terrace Home
- Garage & Parking
- Unfurnished
- Popular Location Close To Amenities
- Enclosed Rear Garden
- Available April 2025

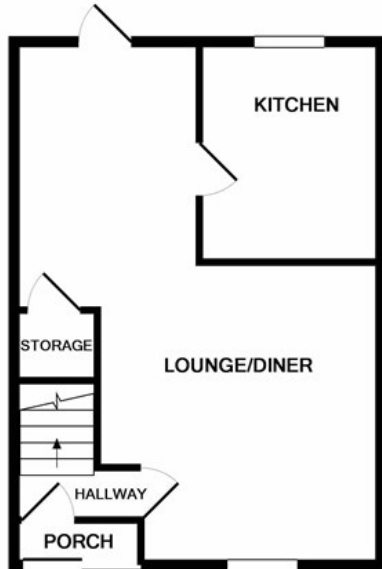

GROUND FLOOR

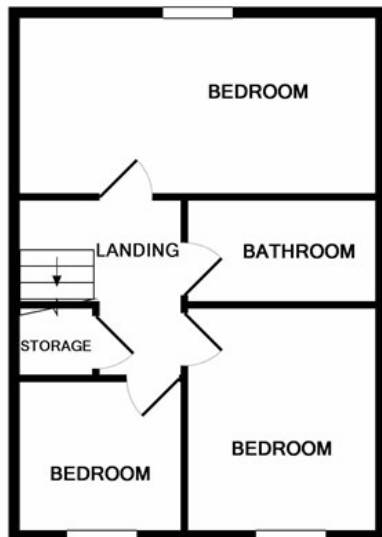

1ST FLOOR

Measurements are approximate. Not to scale. Illustrative purposes only
Made with Metropix ©2017



Full Description

LOUNGE

14'3" x 10'9"

DINING AREA

14'4" x 7'1"

KITCHEN

10'6" x 6'5"

LANDING

MASTER BEDROOM

14'0" x 9'0"

BEDROOM TWO

11'2" x 8'0"

BEDROOM THREE

6'6" x 5'8"

BATHROOM

GARDEN

GARAGE

4 Flaxpits Lane
Winterbourne
Bristol
BS36 1JX

www.aj-homes.co.uk
info@aj-homes.co.uk
01454 252140

Agents Note: Whilst every care has been taken to prepare these sales particulars, they are for guidance purposes only. All measurements are approximate are for general guidance purposes only and whilst every care has been taken to ensure their accuracy, they should not be relied upon and potential buyers are advised to recheck the measurements