



Flaxpits Lane
Bristol BS36 1JX

Price:
£1,250 PCM

Property Features

- First Floor Apartment
- 2 Bedrooms
- Living Room
- New Electric Heating
- New Fitted Kitchen
- New Fitted Bathroom
- Available Immediately
- Unfurnished

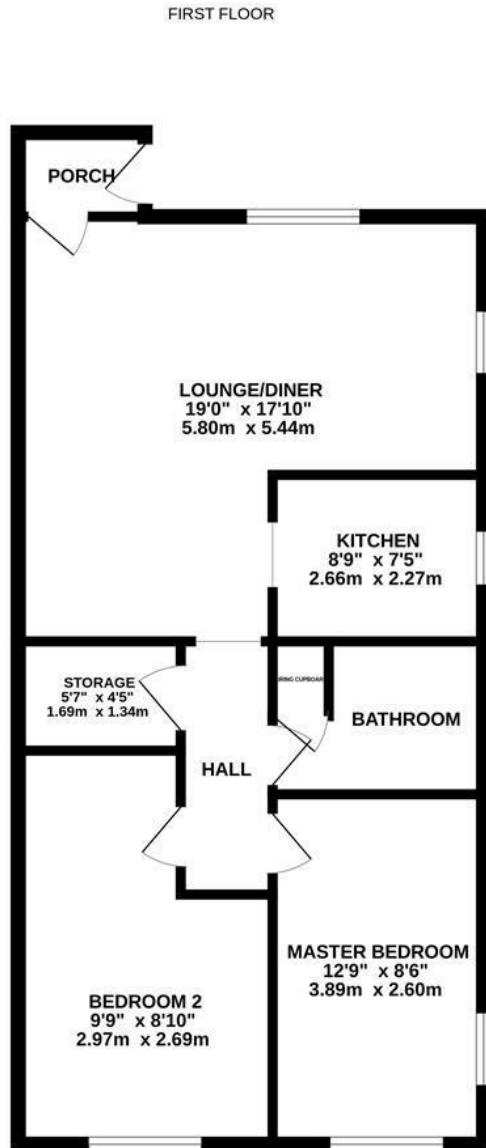

Measurements are approximate. Not to scale. Illustrative purposes only.
Made with Metropix ©2024

Full Description

Entrance Porch

L Shaped Living Room
19'0" x 17'10" (maximum)

Kitchen
8'8" x 7'5"

Inner Hallway

Bedroom 1
12'9" x 8'6"

Bedroom 2
9'8" x 8'9"

Store Room
5'6" x 4'4"

Bathroom

4 Flaxpits Lane
Winterbourne
Bristol
BS36 1JX

www.aj-homes.co.uk
info@aj-homes.co.uk
01454 252140

Agents Note: Whilst every care has been taken to prepare these sales particulars, they are for guidance purposes only. All measurements are approximate are for general guidance purposes only and whilst every care has been taken to ensure their accuracy, they should not be relied upon and potential buyers are advised to recheck the measurements