



**Laddon Mead,
Bristol, BS37 7NG**

PRICE: £1,500 PCM

Property Features

- Available Immediately
- Town House
- Three Bedrooms
- Garage & Parking
- No Pets or Sharers
- Kitchen/Diner
- Great Transport Links
- Some Furniture Included



Full Description

ENTRANCE HALL
Storage cupboard.

CLOAKROOM

KITCHEN/DINING ROOM
16'2" x 10'1" (4.93 x 3.07)
Gas hob and oven. Washing machine and fridge freezer.

LANDING

LIVING ROOM
16'3" x 13'1" (4.95 x 3.99)

BEDROOM 1
16'3" x 10'3" (4.95 x 3.12)
Storage cupboard.

ENSUITE
Double shower, low level w.c and hand wash basin.

BEDROOM 2
16'4" x 12'3" (4.98 x 3.73)

BEDROOM 3
16'3" x 9'3" (4.95 x 2.82)

BATHROOM
Panelled bath with shower over, low level w/c and hand wash basin.



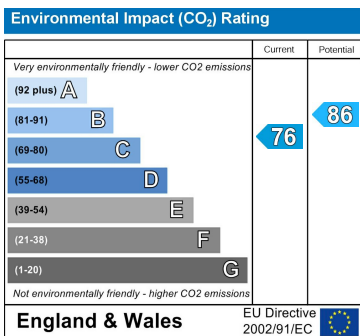
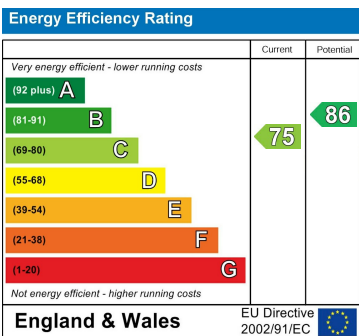

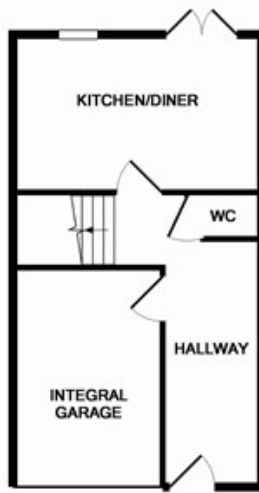

GROUND FLOOR

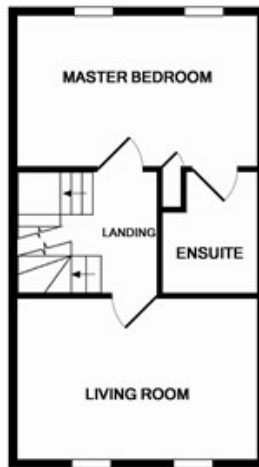

1ST FLOOR

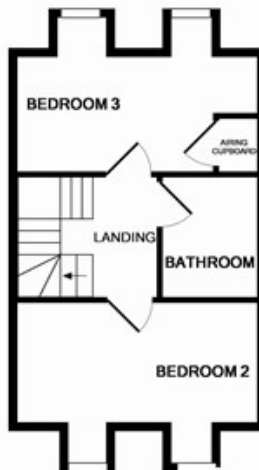

2ND FLOOR

Measurements are approximate. Not to scale. Illustrative purposes only
Made with Metropix ©2019

4 Flaxpits Lane
Winterbourne
Bristol
BS36 1JX

www.aj-homes.co.uk
info@aj-homes.co.uk
01454 252140

Agents Note: Whilst every care has been taken to prepare these sales particulars, they are for guidance purposes only. All measurements are approximate are for general guidance purposes only and whilst every care has been taken to ensure their accuracy, they should not be relied upon and potential buyers are advised to recheck the measurements