

aj homes

**SORRY
ALL VIEWING SLOTS
NOW RESERVED**

aj homes



Dragon Road
Bristol BS36 1BQ



**Price:
£1,200 PCM**

Property Features

- PETS CONSIDERED
- Two DOUBLE Bedroom Character Cottage
- Loft Room & Cellar
- Off Street Parking
- Rear Garden with Storage Shed
- Downstairs Bathroom & Two En-suites
- Available July 2024
- Unfurnished
- Close to Local Shops & Bus Stops



Full Description

LOUNGE
16'7" x 11'1"

DINING AREA
16'1" x 10'0"

KITCHEN AREA
15'11" x 6'1"

LOBBY

BATHROOM
11'0" x 5'9"

CONSERVATORY
13'1" x 7'11"

LANDING

BEDROOM ONE
13'8" x 10'9"

EN-SUITE

BEDROOM TWO
10'0" x 9'4"

LOFT AREA
16'3" x 14'3"

REAR GARDEN

FRONT AREA



CELLAR



GROUND FLOOR

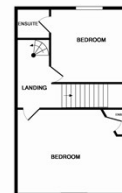

1ST FLOOR

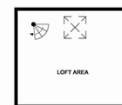

LOFT AREA

Measurements are approximate. They are for guidance purposes only. All measurements are approximate and should not be relied upon. Potential buyers are advised to recheck the measurements.

4 Flaxpits Lane
Winterbourne
Bristol
BS36 1JX

www.aj-homes.co.uk
info@aj-homes.co.uk
01454 252140

Agents Note: Whilst every care has been taken to prepare these sales particulars, they are for guidance purposes only. All measurements are approximate and should not be relied upon. Potential buyers are advised to recheck the measurements.