

Church Road
Bristol BS36 2AQ

Price:
£1,050 PCM

Property Features

- One Bedroom Bungalow
- Living Room
- Kitchen/Dining Room
- Furnished
- Private Garden
- Gas Central Heating
- Available Immediately
- MUST BE VIEWED



Full Description

This furnished one bedroom bungalow with 1 parking space and private garden is perfect for a professional looking a new home. the property has the added benefit of Gas central heating and is located in Frampton Cotterel. Available immediately a viewing is highly recommended.

ENTRANCE HALL

LOUNGE
17'0" x 12'10"

KITCHEN/DINING ROOM
13'11" x 7'11"

BEDROOM
11'0" x 11'0"

BATHROOM

GARDEN

PARKING
OFF STREET PARKING FOR 1 VEHICLE ONLY



GROUND FLOOR

Energy Efficiency Rating	
Current	Potential
88	88

Very energy efficient - lower running costs
 (92 plus) A
 (81-91) B
 (69-80) C
 (55-68) D
 (39-54) E
 (21-38) F
 (1-20) G
 Not energy efficient - higher running costs

England & Wales EU Directive 2002/91/EC

Environmental Impact (CO ₂) Rating	
Current	Potential

Very environmentally friendly - lower CO₂ emissions
 (92 plus) A
 (81-91) B
 (69-80) C
 (55-68) D
 (39-54) E
 (21-38) F
 (1-20) G
 Not environmentally friendly - higher CO₂ emissions

England & Wales EU Directive 2002/91/EC

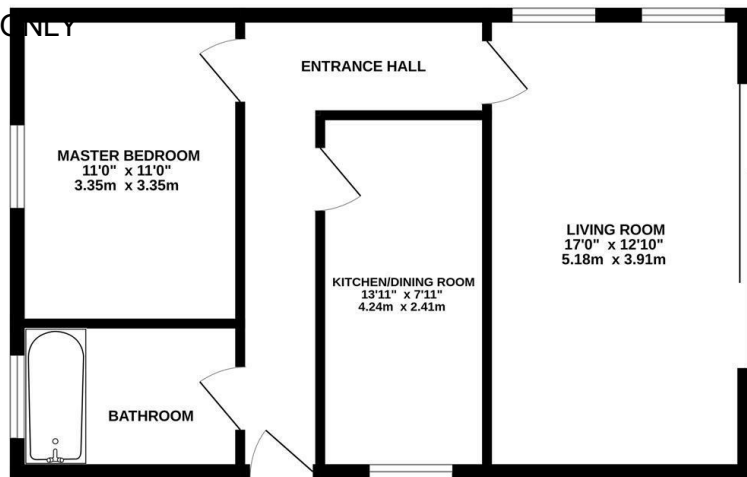

Measurements are approximate. Not to scale. Illustrative purposes only. Made with Metropix ©2024

4 Flaxpits Lane
Winterbourne
Bristol
BS36 1JX

www.aj-homes.co.uk
info@aj-homes.co.uk
01454 252140

Agents Note: Whilst every care has been taken to prepare these sales particulars, they are for guidance purposes only. All measurements are approximate are for general guidance purposes only and whilst every care has been taken to ensure their accuracy, they should not be relied upon and potential buyers are advised to recheck the measurements