

Saxton Mee



Hard Lane Harthill Sheffield S26 7WB
Price £475,000



Hard Lane

Sheffield S26 7WB

Price £475,000

Saxton Mee are delighted to work in partnership with Holman Property Developments to introduce for sale this exciting, bespoke development of seven individual 2, 3 and 4 bedroom homes. North Farm Mews is situated in this picturesque location within the sought after Village of Harthill.

These stylish and contemporary homes will be finished to an unrivalled specification with high quality fixtures and fittings throughout, as well as gas fired central heating with a high efficiency boiler, uPVC double glazing and a 10-year premier guarantee.

Plot 7 forms part of the historic old North Farm. Set over three levels this four bedroom, three bathroom home is being lovingly restored to its former glory whilst being carefully designed for modern living capabilities. As you enter the house via the hallway making your way through the ground floor you will find a downstairs WC and cloakroom store. The lounge will benefit from triple aspect windows which will flood the room with natural light. The expansive kitchen/diner is the hub of this fantastic home with a range of wall, drawer and base units with AEG appliances including a double oven, five ring induction hob, dishwasher, fridge and freezer. Ample space for a dining table and French doors leading onto the garden patio from the dining area. The first floor leads way into the master bedroom with en-suite, double bedroom two and the family bathroom with full tiling to the floor and walls, wash hand basin, WC, bath and shower over. On the top floor, you will find two further large double bedrooms with a shower room.

External to the home are two allocated parking spaces. To the rear is a garden area which is mainly laid to lawn with a patio with patio from the French doors leading off the kitchen/diner.

Please note, Images used are of a similar home and are for illustrative purposes only. For more information on completion dates, please speak with our sales team.

- SOUGHT AFTER LOCATION IN THE VILLAGE OF HARTHILL
- NORTH FARM MEWS - EXCLUSIVE DEVELOPMENT
- BESPOKE PROPERTIES
- HIGH QUALITY FINISHING THROUGHOUT
- FOUR BEDROOMS/TWO BATHROOMS



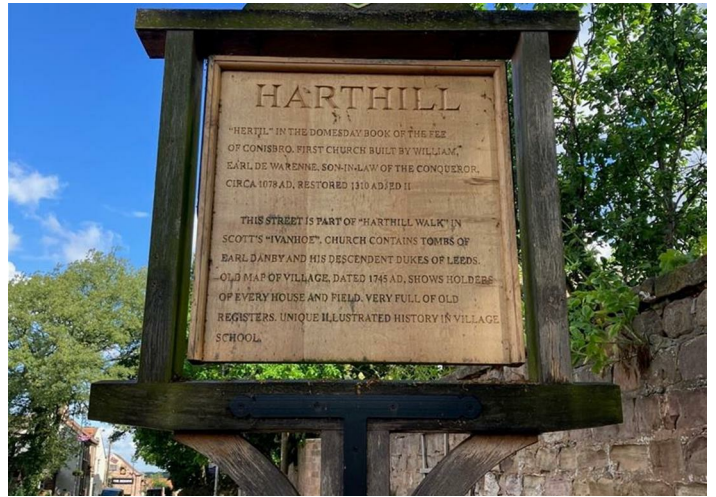

FIXTURES & FITTINGS

Subject to reservation the purchaser will have the option to select fixtures and fittings to include kitchens, bathrooms, flooring in wet areas, internal doors and handles etc. Carpets are not included as standard.

LOCATION

The property has good access to the amenities of Harthill including public houses, shops and local schooling. The M1/M18 motorway networks and the A57 are easily accessible from the property and provide transport links to Sheffield, Rotherham, Worksop, Nottingham and Leeds. The Rother Valley Country Park, Harthill Reservoir and Gulliver's Valley are also a short drive away.

Whilst we endeavour to make our sales particulars fair, accurate and reliable, they are only a general guide to the property. If there is any point which is of particular importance to you, please contact the relevant office. The Agents have not tested any apparatus, equipment, fittings or services and so cannot verify they are in working order. The buyer is advised to obtain verification. All plans, floor plans and maps are for guidance purposes only and are not to scale. Please note all measurements are approximate and should not be relied upon as exact. Under no circumstances should they be relied upon as exact or for use in planning carpets and other such fixtures, fittings or furnishings. YOUR HOME IS AT RISK IF YOU DO NOT KEEP UP REPAYMENTS ON A MORTGAGE OR OTHER LOAN SECURED ON IT.

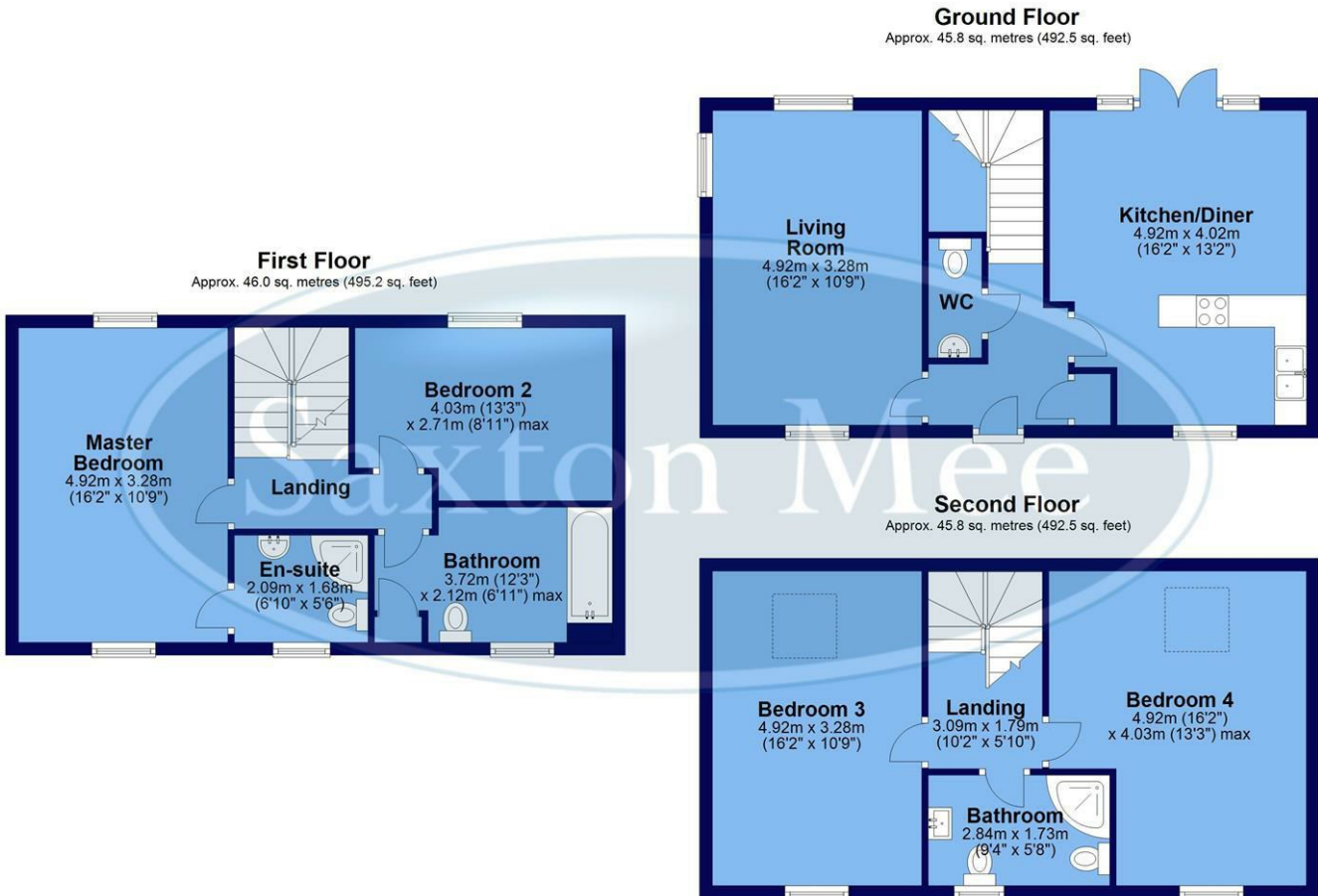

Total area: approx. 137.5 sq. metres (1480.2 sq. feet)

All measurements are approximate
Plan produced using PlanUp.

Crookes
Hillsborough
Stocksbridge

245 Crookes, Sheffield S10 1TF
82 Middlewood Road, Sheffield S6 4HA
462 Manchester Road, Sheffield S36 2DU

T: 0114 266 8365
T: 0114 231 6055
T: 0114 287 0112

www.saxtonmee.co.uk

