



TAYLOR GIBBS

Residential Sales, Lettings & Management Agents

Miranda Road, Whitehall Park, N19
Price £2,250 pcm - To Let

A two bedroom apartment occupying the first floor of a period conversion with direct access to a private section of rear garden situated within close walking distance to Archway Underground Station. Boasting laminate wood floors throughout, the accommodation comprises a spacious reception room which is open plan to the kitchen, two double bedrooms and a bathroom. Externally there is direct access from the hallway to a section of the rear garden. The property has gas central heating, fibre broadband is available on the road and there is street CPZ parking. The property is located in the Whitehall Park Conservation area and is within easy reach of Highgate Village, Crouch End and Waterlow Park.

Council Tax: Islington Band D

Please note that £2,250 per calendar month is the equivalent of £519.23 per week

Tenancy Term: 12 months

Approx. Floor Area: 640 sqft (59.46 sqm)



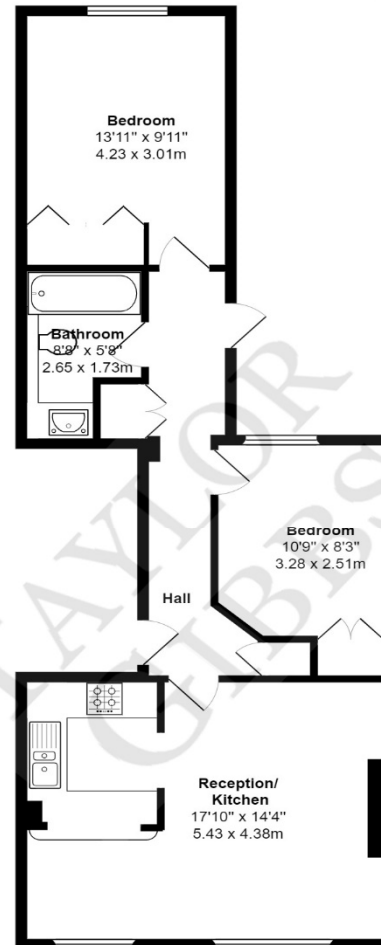

First Floor

Miranda Road N19
Total Area: 640 ft² ... 59.4 m²

All measurements are approximate and for display purposes only

Energy Efficiency Rating		
	Current	Potential
Very energy efficient - lower running costs		
(92-100) A		
(81-91) B		
(69-80) C		79
(55-68) D	69	
(39-54) E		
(21-38) F		
(1-20) G		
Not energy efficient - higher running costs		
England & Wales		
EU Directive 2002/91/EC		



TAYLOR GIBBS

Residential Sales, Lettings & Management Agents

33 Highgate High Street, Highgate, London, N6 5JT
Tel: 020 8341 0123
enquiries@taylorgibbs.co.uk
www.taylorgibbs.co.uk

