



TAYLOR GIBBS

Residential Sales, Lettings & Management Agents

Milton Park, Highgate, N6
Price £599,950 - Share of Freehold

A two bedroom garden flat situated on a quiet road within close walking distance of Highgate Underground Station. Boasting an array of period features and wooden floors throughout, the accommodation comprises of a large reception room leading onto a private garden which overlooks Parkland Walk, a separate fitted kitchen, bathroom and two double bedrooms, the master benefiting from fitted wardrobes. The property is accessed from its own private entrance and is conveniently located within walking distance to the amenities of both Highgate Village and Crouch End Broadway. The property includes a share of the freehold and is available chain free.

Council Tax: London Borough of Haringey - Band D

Approx. Floor Area: 731 sqft (68 sqm)

Remaining Lease Term: 975 years

Annual Service Charge: £600 – Payable £50 per calendar month



| Energy Efficiency Rating | | Current | Potential |
|--|--|----------------------------|-----------|
| <i>Very energy efficient - lower running costs</i> | | | |
| (92 Plus) A | | | |
| (81-91) B | | | |
| (69-80) C | | | |
| (55-68) D | | 64 | 78 |
| (39-54) E | | | |
| (21-38) F | | | |
| (1-20) G | | | |
| <i>Not energy efficient - higher running costs</i> | | | |
| England & Wales | | EU Directive 2002/91/EC | |

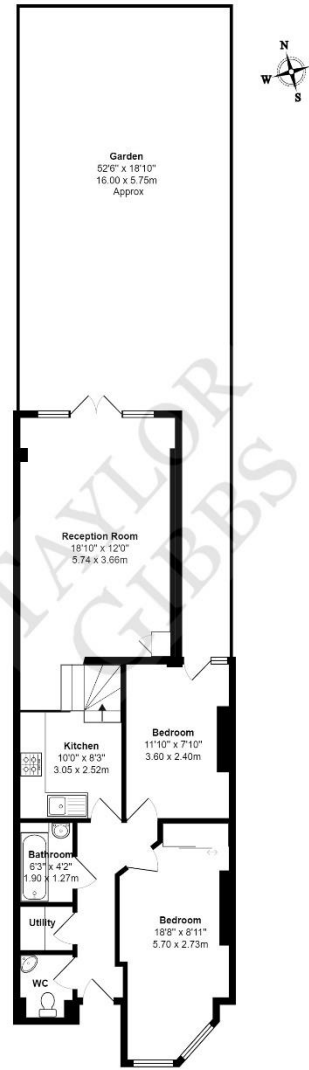

Lower Ground Floor

70a Milton Park N6
 Total Area: 731 ft² ... 68.0 m²
 All measurements are approximate and for display purposes only



