



## Wisteria Road, SE13

£1,400 Per calendar month

A one bedroom raised ground floor Victorian apartment conveniently situated between Lewisham and Hither Green stations. Comprising entrance hall with wood flooring, open-plan reception room/kitchen at the front. Double bedroom and separate bathroom with four piece suite.

Wisteria Road is located in Hither Green, an exciting and fast-developing area that borders Blackheath and Lewisham. The nearest station is Hither Green with services direct to London Bridge, Charing Cross and Canon Street. Lewisham station is also within easy reach where you can also pick up the DLR for connections to Canary Wharf and Bank

### Features

Second Floor Flat  
One Double Bedroom  
Victorian Conversion  
Open Plan Kitchen / Reception  
Excellent Location  
Wooden Floor Throughout

Wisteria Road,  
London, SE13

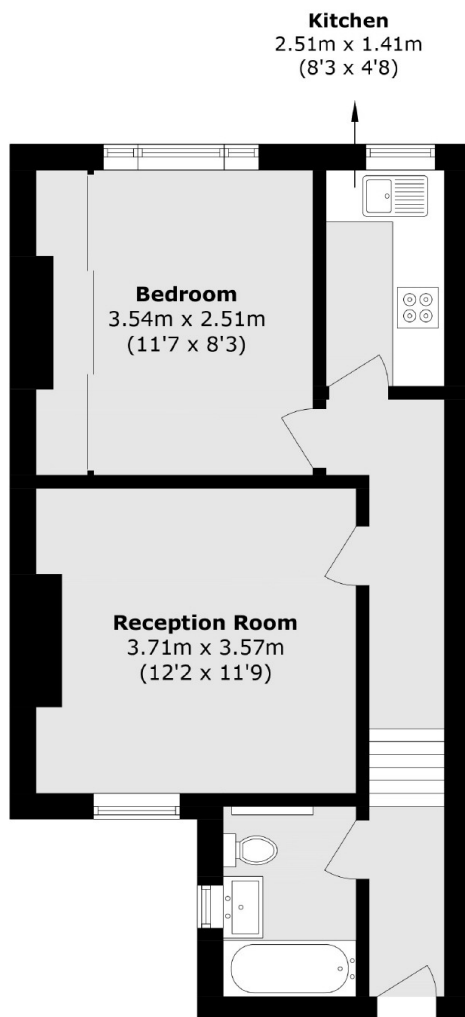

Total area (approx.): 40.2 sq. m (432.7 sq. ft)

**Dexters**

Lewisham  
228 Algernon Road  
London  
SE13 7AG  
Lettings  
0208 690 8020

Energy Rating: . We aim to make our particulars both accurate and reliable. However they are not guaranteed; nor do they form part of an offer or contract. If you require clarification on any points then please contact us, especially if you're traveling some distance to view. Please note that appliances and heating systems have not been tested and therefore no warranties can be given as to their good working order.

 **RICS** | Regulated  
Estate Agent  
and Letting Agent

[dexters.co.uk](https://www.dexters.co.uk)