

## Coulgate Street, SE4

£2,200 Per calendar month

A modern two bedroom, one bathroom apartment is located within easy reach of Brockley station. The property also has a private balcony.

Brockley station is a short walk away from where there are fast and frequent services into London Bridge. In addition, you can pick up the London Overground towards Shoreditch and Highbury and Islington meaning that Canary Wharf is a mere 30-minute commute changing at Canada Water.

### Features

- Modern Development
- Two Double Bedrooms
- One Bathroom
- Private Balcony
- Excellent Condition
- Close To Brockley Station

# Coulgate Street, London, SE4

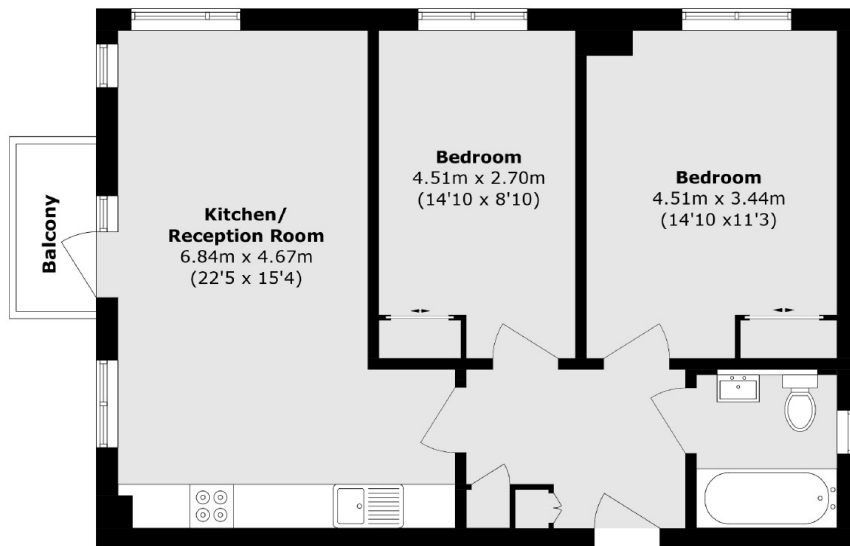

Total area (approx.): 67.5 sq. m (726.6 sq. ft)

Balcony area (approx.): 2.5 sq. m (26.9 sq. ft)

## Dexters

Lewisham  
228 Algernon Road  
London  
SE13 7AG  
Lettings  
0208 690 8020

Energy Rating: D. We aim to make our particulars both accurate and reliable. However they are not guaranteed; nor do they form part of an offer or contract. If you require clarification on any points then please contact us, especially if you're traveling some distance to view. Please note that appliances and heating systems have not been tested and therefore no warranties can be given as to their good working order.

 **RICS** | Regulated  
Estate Agent  
and Letting Agent

[dexters.co.uk](https://www.dexters.co.uk)