



Ermine Road, SE13

£3,500 Per calendar month

A double fronted period house on this sought-after residential street that offers period charm, high ceilings, five generous bedrooms and off-street parking.

Ermine road is a lovely residential road located just around the corner from Hilly Fields and between St. John's, Lewisham and Ladywell train stations giving excellent transport links.

Features

- Period House
- Five Double Bedrooms
- Two Bathrooms
- Private Garden
- Off-Street Parking
- Ladywell Village



Ermine Road, SE13

On the ground floor comprises a large double reception / dining room leading to a recently refurbished kitchen with a breakfast bar and direct access to a private garden.

The first floor has three large double bedrooms that surround the family bathroom. The second floor has two more bedrooms and a walk-in shower room. The house also benefits from a lower ground utility, store room and separate W.C.



Ermine Road, London, SE13



Ground Floor

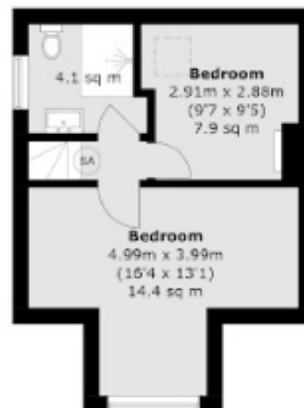

Second Floor



Lower Ground Floor



First Floor

Total area (approx.): 200.6 sq. m (2,159.2 sq. ft)

Dexters

Lewisham
228 Algernon Road
London
SE13 7AG
Lettings
0208 690 8020

Energy Rating: E. We aim to make our particulars both accurate and reliable. However they are not guaranteed; nor do they form part of an offer or contract. If you require clarification on any points then please contact us, especially if you're traveling some distance to view. Please note that appliances and heating systems have not been tested and therefore no warranties can be given as to their good working order.

RICS Regulated
Estate Agent
and Letting Agent

dexters.co.uk