



## Ladywell Road, SE13

£1,900 Per calendar month

A two bedroom ground floor Victorian garden flat comprising reception room, two bedrooms, a family size bathroom, fitted kitchen and a private rear garden.

Ladywell Road is within a short walk of Ladywell Station with regular services into Central London. You also have a choice of amenities and local coffee shops close by.

### Features

- Ground Floor Flat
- Private Garden
- Two Double Bedrooms
- Separate Fitted Kitchen
- Modern Bathroom
- Ladywell Village

Ladywell Road,  
London, SE13

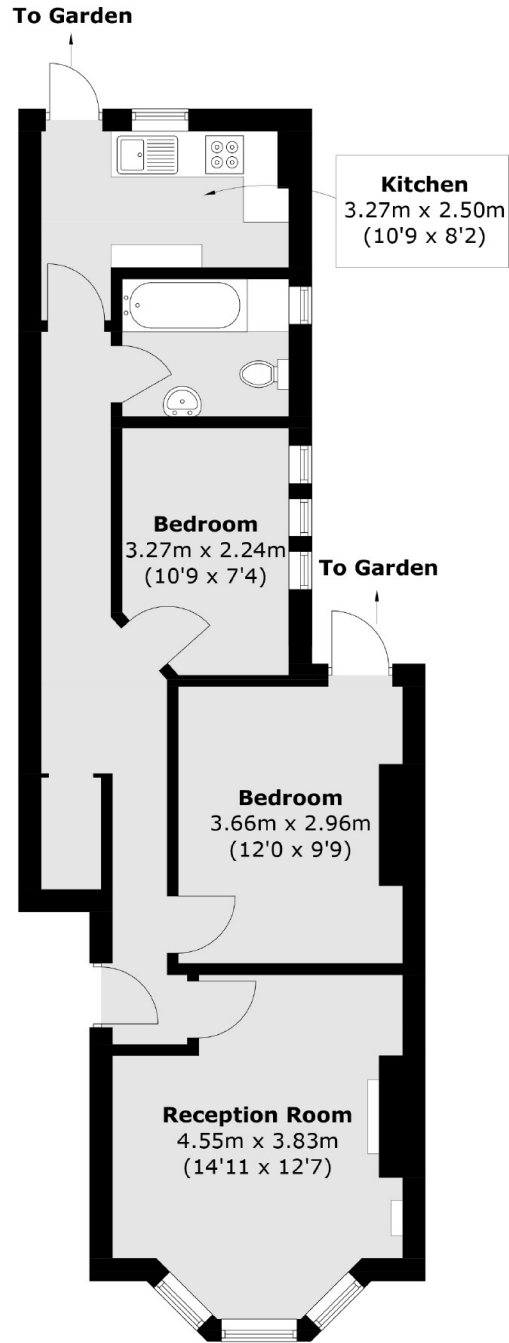

Total area (approx.): 57.4 sq. m (617.8 sq. ft)