



Minard Road, SE6

£1,800 Per calendar month

A well presented two bedroom ground floor Victorian conversion flat which is situated on the popular "Corbett" estate. The property offers spacious living accommodation which comprises entrance hall, a large double bedroom, a second double bedroom with doors to the private garden, an open plan kitchen / reception room and a modern shower room.

Located half a mile from Hither Green station with trains to London Bridge in 13 minutes and 0.9 miles from Catford Town Centre with its high street retailers.

Features

- Ground Floor Flat
- Own Private Entrance
- Two Double Bedrooms
- Open Plan Kitchen / Reception
- Conservation Area
- Private Garden

Minard Road, London, SE6

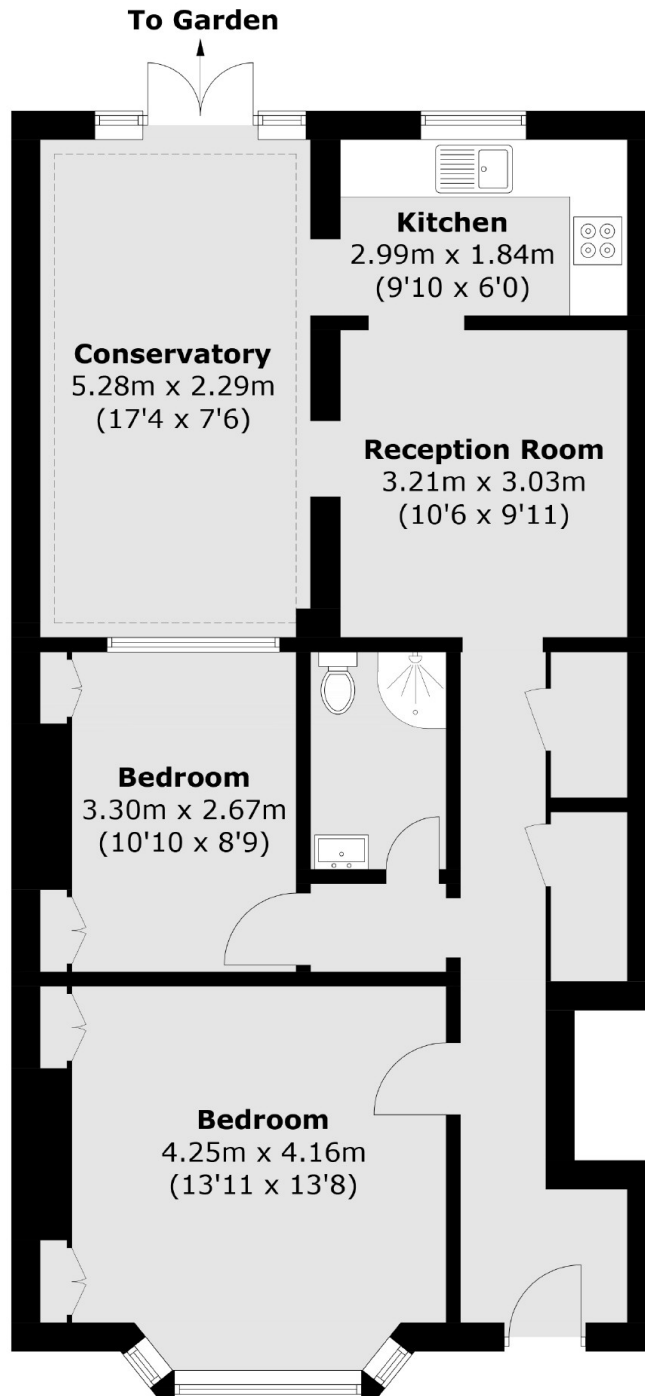

Total area (approx.): 75.2 sq. m (809.4 sq. ft)