



George Lane, SE13

£1,500 Per calendar month

A modern one bedroom apartment in a converted cinema. Offering a secure video entry system, secure bike storage and residential permit parking upon request.

Situated just 0.4 miles to Hither Green station and close to local boutique coffee shops.

Features

- Second Floor Flat
- One Bedroom
- Open Plan Reception Room/
Kitchen
- Modern Bathroom
- Secure Building

George Lane, London, SE13

George Lane, SE13

Approximate Gross Internal Area = 57.4 sq m / 618 sq ft

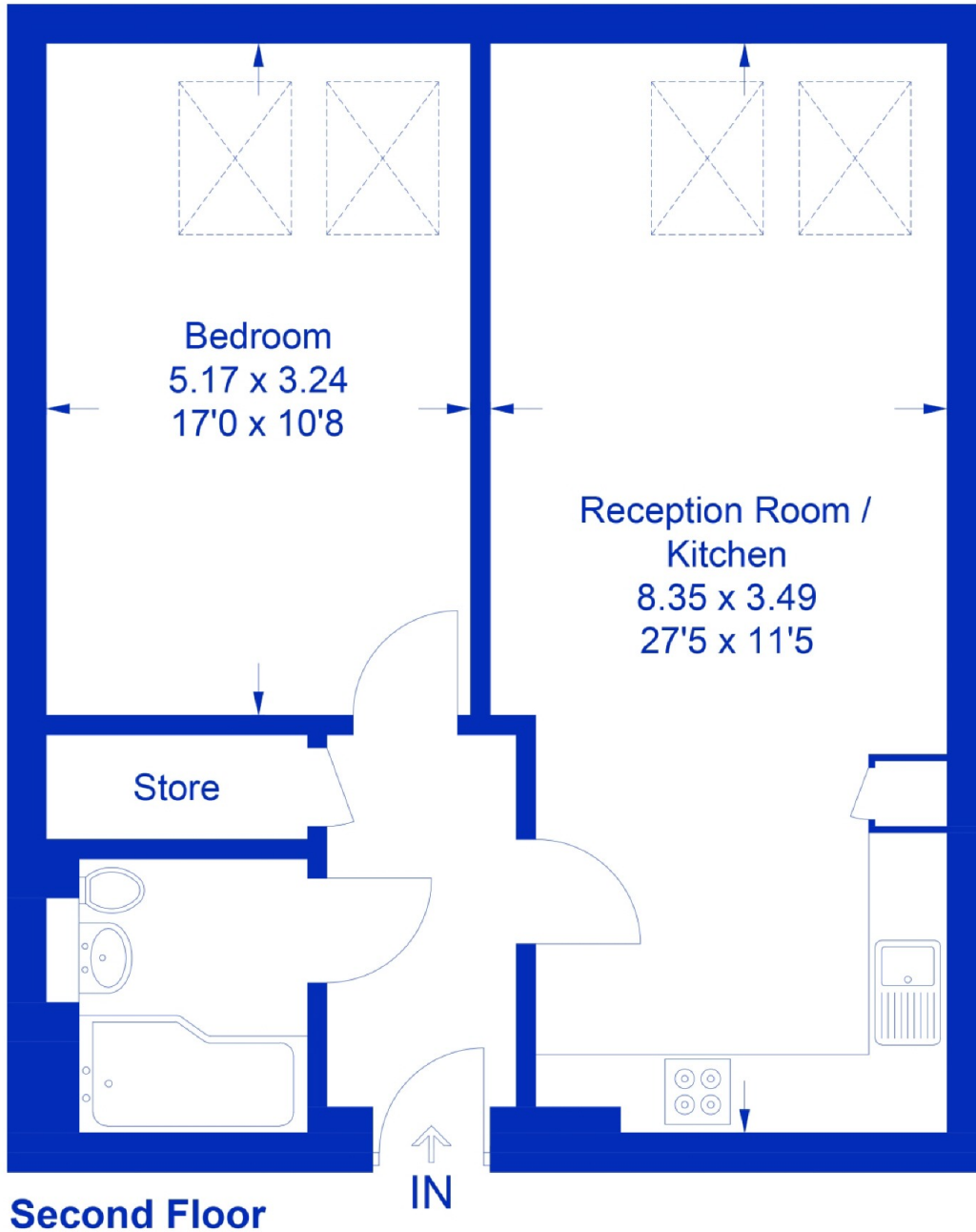

Second Floor

This plan is for layout guidance only. Not drawn to scale unless stated. Windows and door openings are approximate. Whilst every care is taken in the preparation of this plan, please check all dimensions, shapes and compass bearings before making any decisions reliant upon them. (ID740009)