



Lewisham Park, SE13

£2,000 Per calendar month

A rare opportunity to rent this stunning ground floor flat within this Victorian building. Upon entrance you are greeted with a wide entrance hall that leads to a generous reception with feature fire place and high ceilings. The fitted kitchen has been recently refurbished and features brand new appliances. The property also boasts off-street parking, wood floors throughout and a private garden.

Ladywell and Hither Green stations are both within walking distance providing links to the City, while Lewisham provides the DLR for services to Canary Wharf and Bank. Local open spaces such as Lewisham Park and Ladywell Fields are great places for a leisurely stroll or those morning runs.

Features

- Ground Floor Flat
- High Ceilings
- Two Bedrooms
- Spacious Reception
- Separate Fitted Kitchen
- Off Street Parking

Lewisham Park, London, SE13

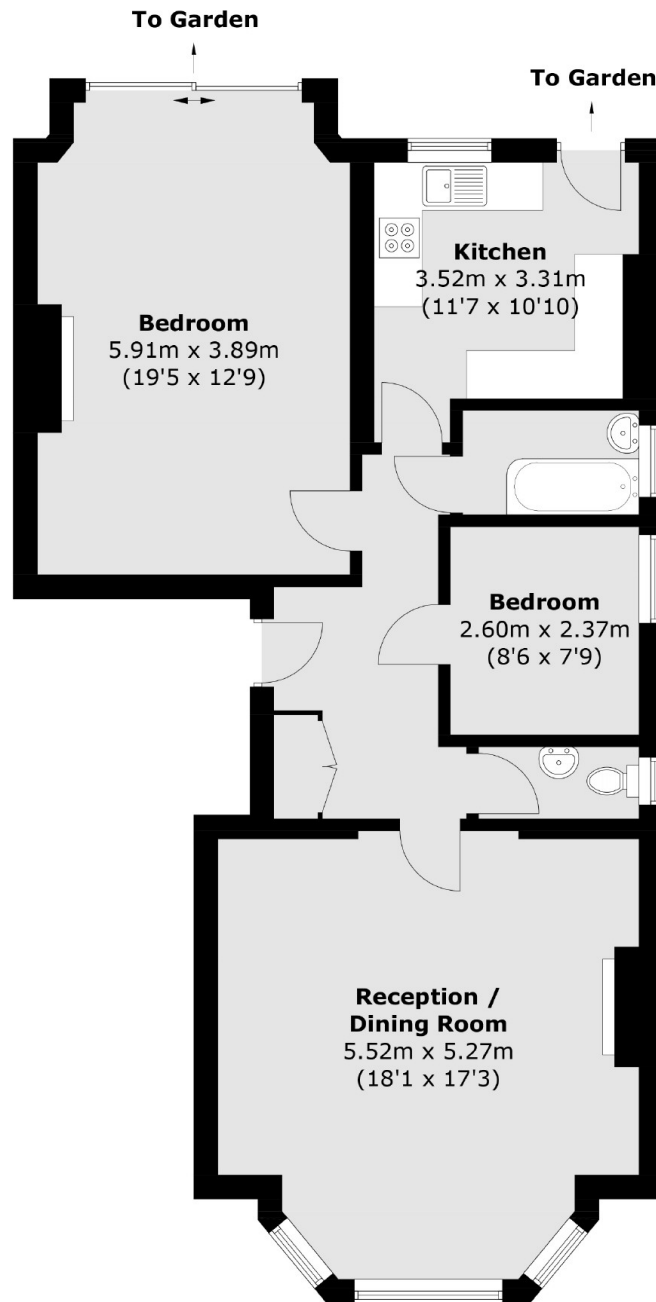

Total area (approx.): 82.8 sq. m (891.2 sq. ft)