

Kingwood Road

£5,500 Per Month





Kingwood Road

£5,500 Per Month	3 BED House - Terraced	0000 SQ FT	0000 SQ M
------------------	---------------------------	---------------	--------------

Available from June to October, the house is thoughtfully decorated and excellently presented throughout due to the owner having a keen eye for presentation. The welcoming double reception room leads to a large eat in kitchen which can be separated from the dining area with sliding doors. The kitchen provides built in oven and microwave, plate warmer, dishwasher and excellent storage. The kitchen then leads to both a handy utility room and sizeable private patio garden. The first floor comprises of a master bedroom with huge walk in wardrobe, family bathroom and second double bedroom which overlooks the garden. The second floor contains a further double bedroom with ensuite bathroom and plenty of storage as in built desk/make up area.

- Three double bedrooms
- Two bathrooms
- Munster Village
- Eat in kitchen
- Private garden
- Utility room
- Large walk in wardrobe
- Double reception
- Furnished
- Available from 06/06/24

Kingwood Road is located in a popular area in 'Munster Village'. It's also not far from the shops, restaurants and amenities of Fulham Road and there are several independent cafes and shops closer to hand on the Munster Road itself. There are plenty of Nursery & Primary Schools close. The closest underground station is either Parsons Green or Fulham Broadway (District Line, Zone 2) which is within walking distance, and you can catch regular buses from Fulham Palace Road north to the transport hub of Hammersmith (Piccadilly, District and Hammersmith & City Lines). Buses also run towards Chelsea and central London from the Fulham Road. The Thames riverside walk and Bishops Park (popular with families) is also a real bonus being only a short walk away. EPC – C

ANDREW SHAW
02073846790
andrew@brik.co.uk







Location

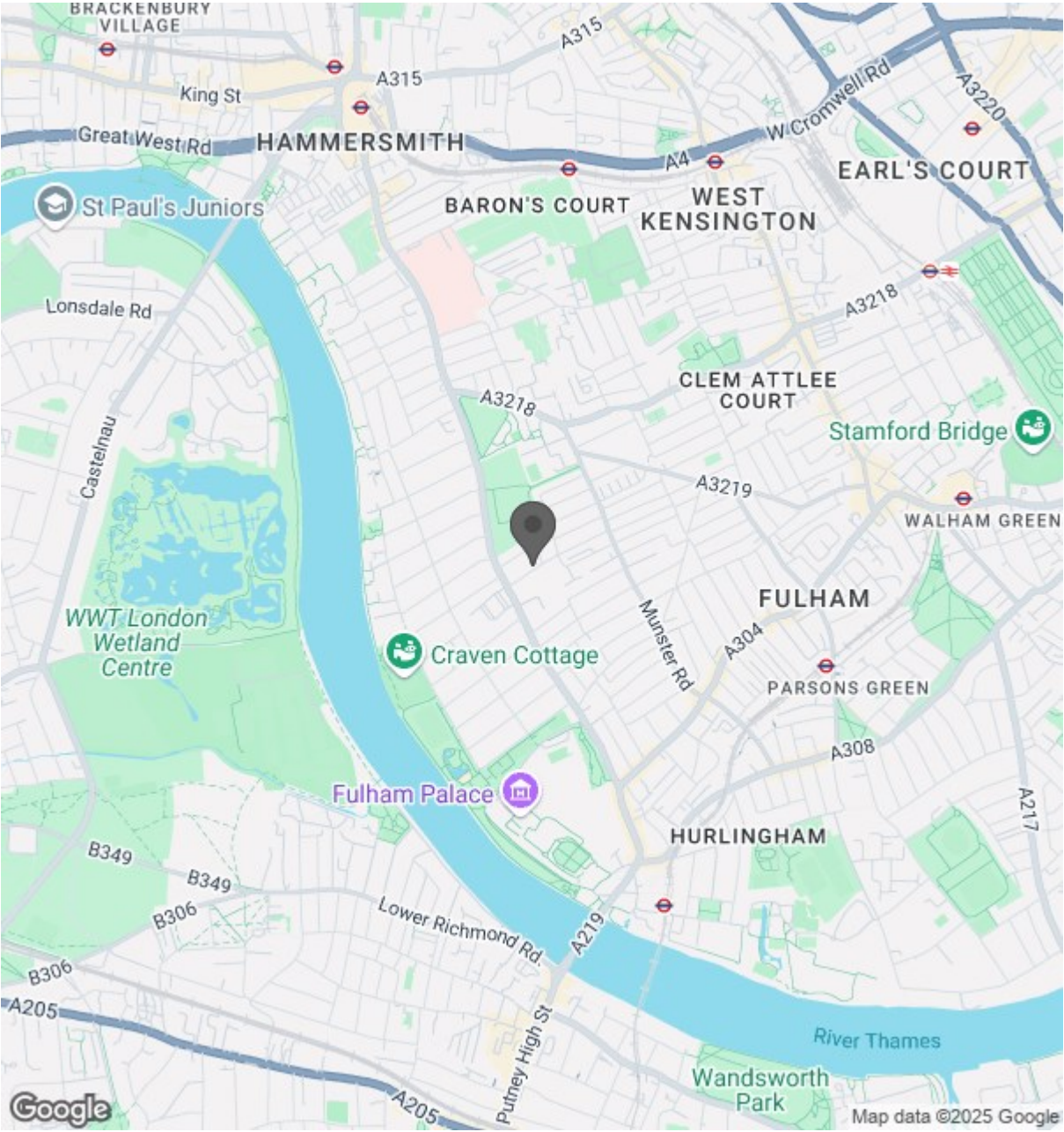

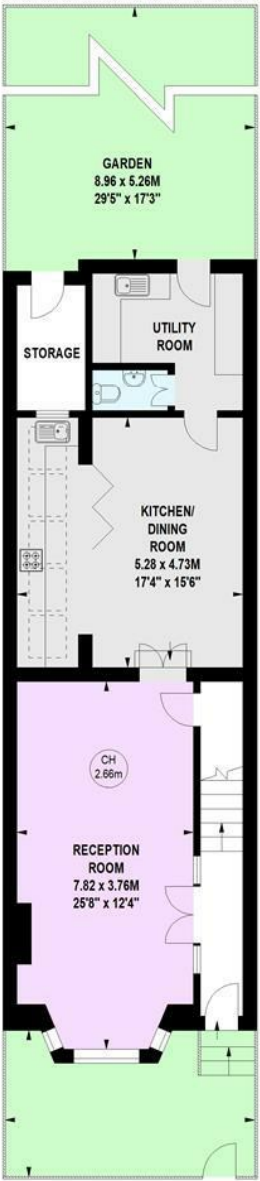

Ground Floor

Kingwood Road, SW6
Approximate gross internal area
160.72 sq m / 1730 sq ft
(Including Eaves Storage & Storage)
Eaves Storage
4.74 sq m / 51 sq ft
Storage
3.90 sq m / 42 sq ft



Key :
CH - Ceiling Height



First Floor



Second Floor

Not to scale, for guidance only and must not be relied upon as a statement of fact.
All measurements and areas are approximate only