

Drive Mansions, SW6

£725,000

BRIK





Drive Mansions

£725,000 | 2 Bed | 801 | 74.4 | E | £26,250 (from 1st April 2025)
 LEASEHOLD | FLAT | SQ FT | SQ M | COUNCIL TAX | STAMP DUTY

A stunning two double bedroom, top floor apartment, with superb views across London, located in the sought after Drive Mansions on Fulham Road.

This charming apartment is presented to a high standard throughout, extends to over 800 sq ft (74 sq m) with generous proportions, has plenty of natural light throughout and has excellent ceiling height. There is impressive entertaining space at the rear of the flat in the form of a large reception room with a period fireplace and large bay window with stunning views over the communal garden and the London skyline. There is also a separate kitchen with plentiful storage, quartz work surface and integrated appliances. There are two double bedrooms, both with fitted storage and a modern bathroom.

Drive Mansions is a desirable Mansion block which is very well maintained and well managed privately. Being situated on the Fulham Road it is conveniently located for its numerous surrounding shops, bars and restaurants, and is also just a short walk from Bishop's Park. It also benefits from various transport links with Parsons Green and Putney Bridge underground stations (District Line) being a short distance away, as well as a good range of bus routes including the number 14. EPC rating - C

- ✓ Two double bedrooms
- ✓ Bathroom
- ✓ Reception room
- ✓ Modern kitchen
- ✓ Large communal garden
- ✓ Long lease (975 years remaining)
- ✓ Excellent storage
- ✓ Great location
- ✓ Approx 801 sq ft (74 sq m)
- ✓ Council tax band - E



Jessica G. Williams

SALES ASSOCIATE
 +7 YEARS EXPERIENCE

☎ 020 7384 6790

✉ jess@brik.co.uk





FULHAM AREA GUIDE

Munster Village

Serviced by some great bars, shops and restaurants, the Munster Village is an extremely popular part of Fulham, attracting buyers to a more affordable alternative to nearby Parsons Green.

There's a wide range of residential property, from smaller but perfectly formed Victorian cottages on Orbain Road to grander family homes on Gowan Avenue, whilst Danehurst Street attracts young professionals with its larger than average purpose built Victorian flats which come complete with their own front doors. With many green spaces nearby including the enchanting grounds of Fulham Palace, the Munster Village is an ever-popular location.

CLOSEST:

- 🚶 Putney Bridge (8 mins)
- 🚶 West Brompton (24 mins)
- 🚶 Bishops Park (13 mins)

KEY:

- 📍 Property location
- ▭ 'Munster Village' area of Fulham

[Read all our Fulham area guides here](#)

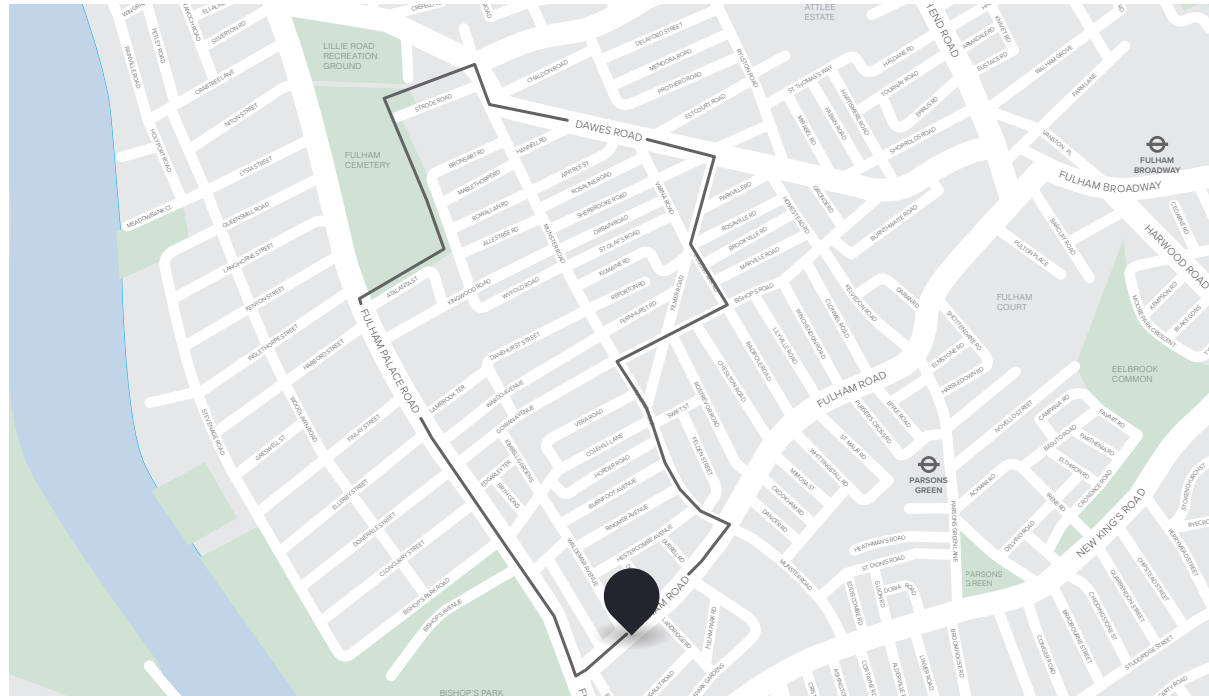

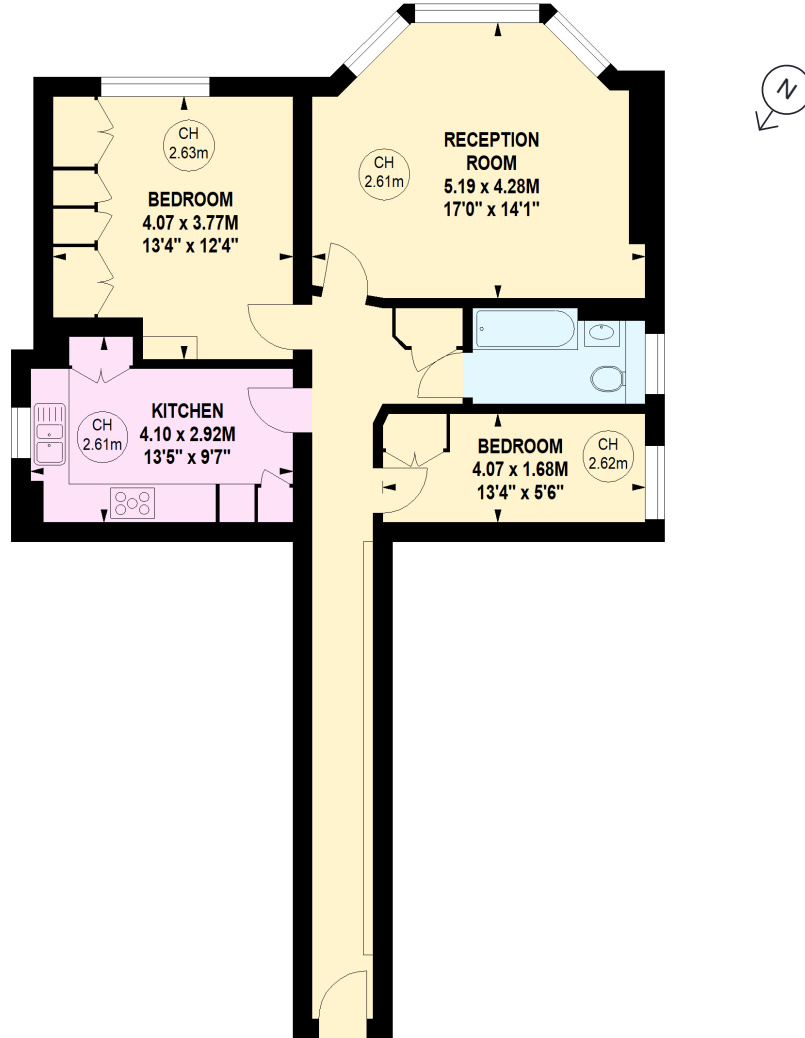

Third Floor