

Homestead Road

Guide Price £475,000





Homestead Road

£475,000

Leasehold

1 BED

Flat

0000

SQ FT

0000

SQ M

The property features a bright bedroom with a bay window and fitted wardrobes, a modern bathroom suite, a reception which leads on to a large kitchen with plenty of wall & base units and space for dining under a sky light ceiling. The property also benefits from a small patio to the front.

Homestead Road is an attractive residential road, within easy walking distance of both Fulham Broadway (the busy centre of Fulham) and Parsons Green, providing residents with a choice of superb shopping and recreational facilities, including plenty of independent cafes, boutique shops, a cinema, David Lloyd (gym) and both a large Waitrose. The closest underground stations are Parsons Green and Fulham Broadway (both District Line, Zone 2) where you can also catch a variety of bus lines that run from Fulham Broadway towards Chelsea and Central London.

- Large Bedroom
- Modern bathroom
- Patio garden to the front (not demised)
- Kitchen/breakfast room
- 526 sq ft / 49 sq m
- No onward chain
- Long lease
- Own front door
- EPC rating – C

MATHEW GOSS

020 7384 6790

mathew@brik.co.uk







Location

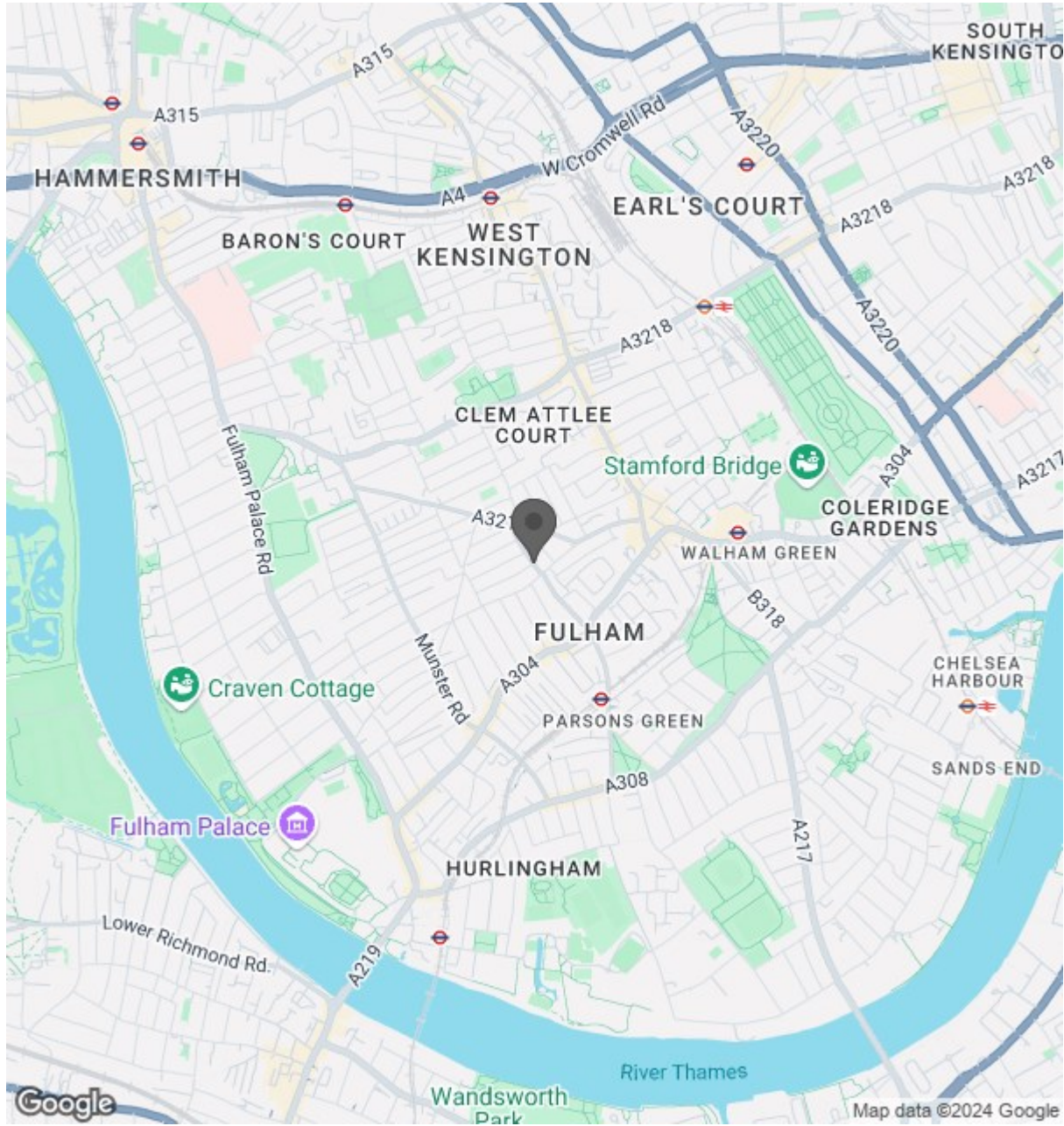

Homestead Road, SW6

Approximate gross internal area
48.87 sq m / 526 sq ft

Key:
CH - Ceiling Height

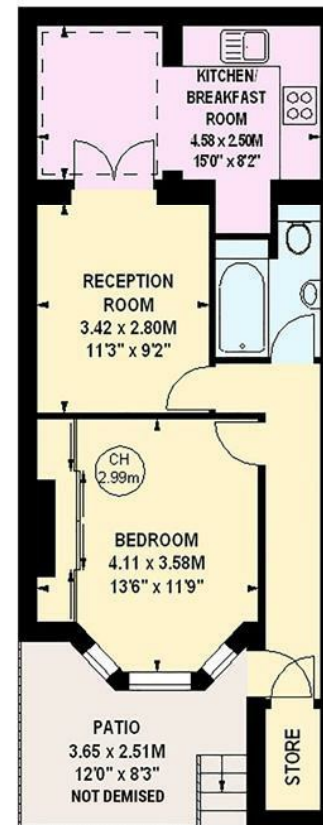
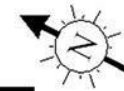

Lower Ground Floor

The floor plan is not to scale and measurements and areas shown are approximate and therefore should be used for illustrative purposes only. The plan has been prepared in accordance with the RICS code of Measuring Practice and whilst we have confidence in the information produced, it must not be relied on. If there is any aspect of particular importance, you should carry out or commission your own inspection of the property.
Copyright of FeaturePRO.