

# Kings Court

£799,950



# Kings Court Mansions

£799,950

Leasehold

2 BED

Flat

0000

SQ FT

0000

SQ M

The reception room has lovely high ceilings with wooden floors running throughout, there is ample space for a large set of sofas and coffee table, behind is the kitchen/breakfast with shaker style units and a butler sink. To the front are two exceptionally large double bedrooms, the bathroom comprises a bath with shower above and sink. There is a separate WC directly next door. EPC: D rating

Kings Court Mansions is ideally located on the Fulham Road with easy access to Parsons Green which has a wealth of shops, restaurants, local supermarkets and pubs. There are also plenty of green spaces a short walk away such as Eel Brook Common, Parsons Green and Hurlingham Park. The area is well served with transport from Parsons Green tube station (District Line), Fulham Broadway (District Line), West Brompton (Overground) as well as having regular bus routes into central London and beyond.

- Two large double bedrooms.
- Kitchen/Breakfast room.
- Beautifully presented.
- High ceilings.
- Large reception room.
- Modern bathroom with separate WC.
- Second floor.
- 5 Minutes to Parsons Green Station.
- Period mansion flat.
- 901 Sqft / 83.7sqm.

**MATHEW GOSS**

020 7384 6790

matthew@brik.co.uk













# Location

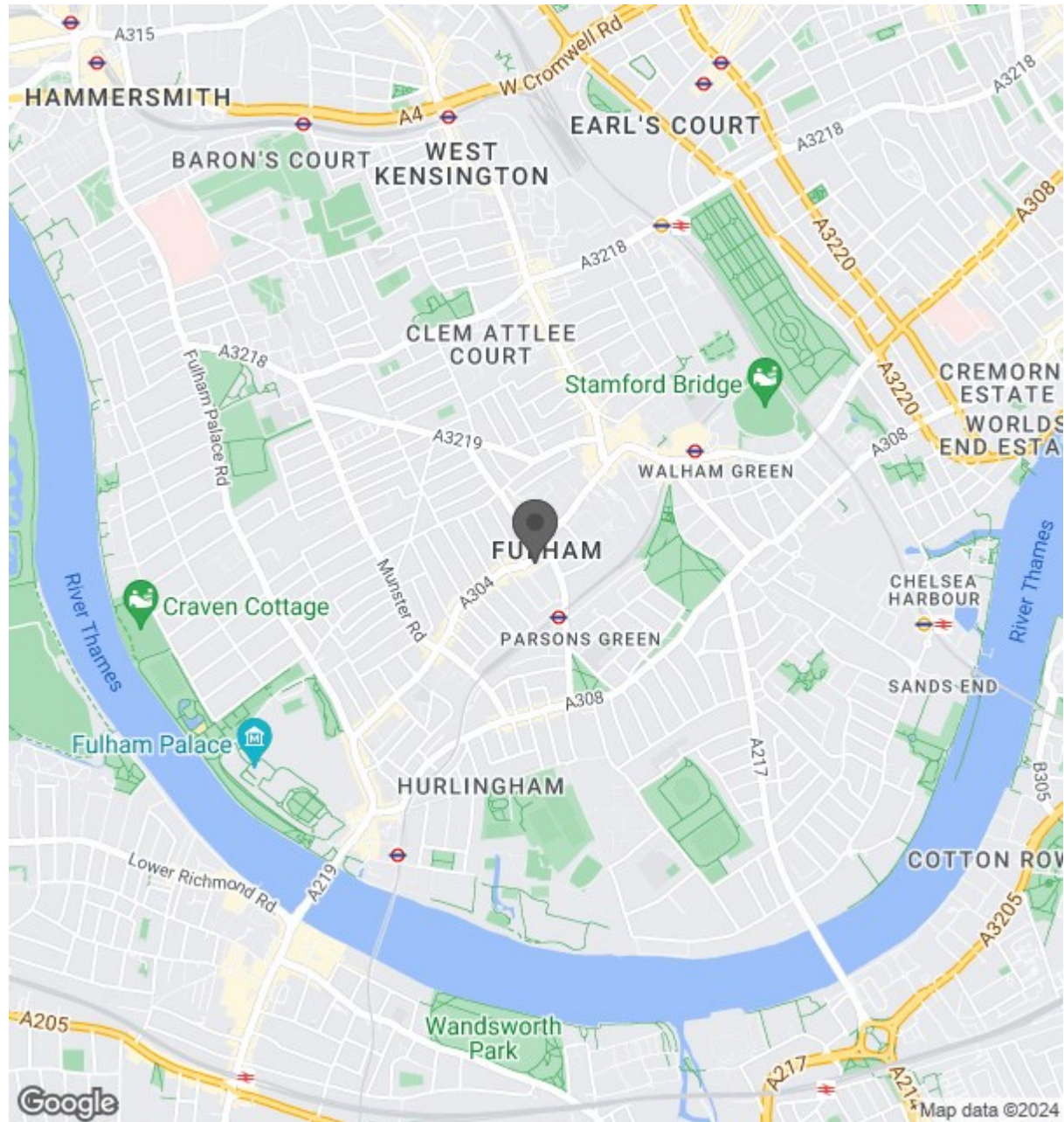

### Kings Court Mansions, SW6

Approximate gross internal area

83.70 sq m / 901 sq ft

Key :  
CH - Ceiling Height

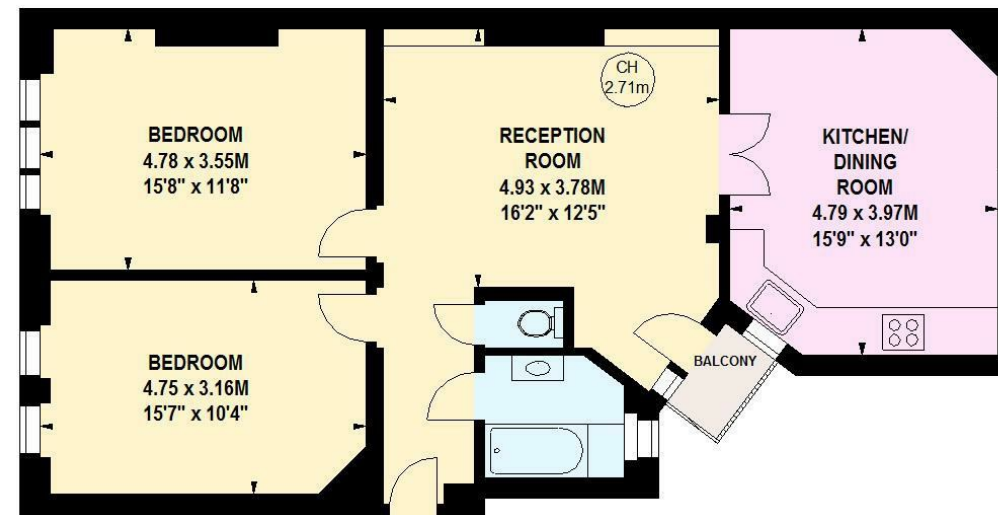
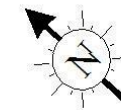

Second Floor