

Franklyn James



Taeping Street

, London, E14 9UT

Asking Price £700,000

OFFERED CHAIN FREE! - This stunning family home is a beautiful three-bedroom terraced house, designed to a high standard and perfect for modern living. Spread over two floors, the property offers a spacious and inviting layout. On the ground floor, you'll find an entrance hall leading to a fitted kitchen, with appliances, bathroom and shower room. The living room opens to a private garden.

Upstairs, there are two generous double bedrooms, one single, each filled with natural light thanks to the large, double-glazed windows. A well-appointed family bathroom serves the first floor, offering both convenience and comfort.

Additional features include private parking, double glazing and LED lighting throughout, making this property a warm and energy-efficient family home. Taeping Street is close to the greenery of Mudchute Park and Farm and the Greenwich foot tunnel.

Ideally located in one of the Isle Of Dogs' charming developments and within a 3-minute walk of Mudchute DLR Station which provides excellent transport links to the City and Canary Wharf.

- No chain
- Terrace house
- Prime location
- Generous accommodation
- Charming development
- Easy access to The city and Canary Wharf
- 3-min walk from Mudchute Station
- 959 lease years remaining

Viewing

Please contact our Westferry Sales Office on 02070056080 if you wish to arrange a viewing appointment for this property or require further information.

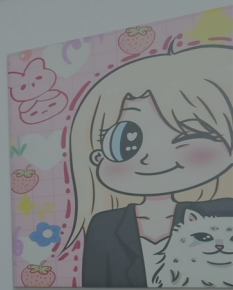

Floor Plan

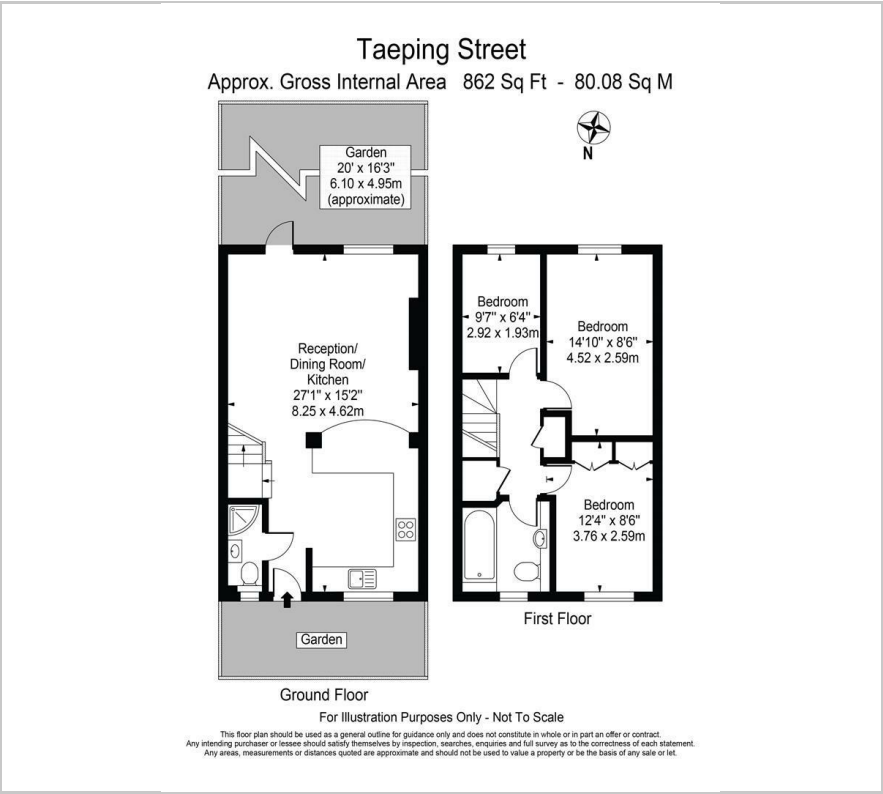

Area Map



Energy Efficiency Graph

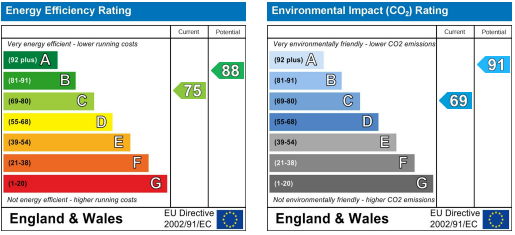

These particulars, whilst believed to be accurate are set out as a general outline only for guidance and do not constitute any part of an offer or contract. Intending purchasers should not rely on them as statements of representation of fact, but must satisfy themselves by inspection or otherwise as to their accuracy. No person in this firms employment has the authority to make or give any representation or warranty in respect of the property.